

Heavy Series Pipe Clamps

Complete Assembly Ordering Code

chart 1 chart 2 chart 3 chart 4 chart 5 chart 6
SH T 41050-PPSB-MET

Clamp Configuration chart 1	
SH	Single Heavy Complete Clamp for Weld Mounting
DH	Double Heavy Complete Clamp for Weld Mounting
R7H	Complete Clamp for mounting to RAL-4 (H3-H5)
R8H	Complete Clamp for mounting to RAL-4 (H6)
R9H	Complete Clamp for mounting to RAL-4 (H7)
UH	Complete Clamp for mounting to Strut Channel
HSK	Heavy Stacking Kit
OH	Single Heavy Clamp with no Bottom Plate

Hardware Material chart 2	
Omit	Untreated Carbon Steel
T	AISI 304 Stainless Steel (A2 - 1.4301/1.4305)
X	AISI 316/316Ti Stainless Steel (A4 - 1.4401/1.4571)
Z	Electro-Zinc Dichromate Plating

Clamp Pair Design chart 4	
Omit	Ribbed Inside
SB	Smooth Bore Inside (groups H3-H6 only)

Clamp Pair Material chart 5	
PP	Polypropylene
SP	Santoprene
AL	Aluminum

Threads chart 6	
Omit	UNC Thread (Standard)
MET	Metric Thread

Clamp Group and Size chart 3					
Behringer Group	Pipe Size	Tube Size	Metric OD (mm)	Imperial OD (Inch)	Order No.
H3		1/4	6.4	0.250	3025
		3/8	9.5	0.375	3038
	1/8		10.0	0.405	30405
		1/2	12.7	0.500	3050
	1/4		13.7	0.540	30540
	3/8		16.0	0.620	3062
H4		3/4	19.0	0.750	4075
			20.0	0.790	4079
	1/2		21.3	0.840	40840
		7/8	22.2	0.875	4087
		1	25.4	1.000	4100
	3/4		26.7	1.050	41050
H5			30.0	1.181	41181
		1 1/4	32.0	1.250	5125
	1		33.4	1.315	51315
		1 1/2	38.1	1.500	5150
	1 1/4		42.2	1.660	51660
	1		42.2	1.660	61315
H6	1 1/4		42.2	1.660	61660
		1 3/4	44.5	1.750	6175
	1 1/2		48.3	1.900	61900
		2	50.8	2.000	6200
		2 1/8	54.0	2.125	62125
		2 1/4	57.2	2.250	6225
H7	2		60.3	2.375	62375
		2 1/2	63.5	2.500	6250
		2 3/4	69.9	2.750	6275
		2 3/4	69.9	2.750	7275
	2 1/2		73.0	2.875	72875
		3	76.2	3.000	7300
H8	3	3 1/2	88.9	3.500	7350
		3 1/2	88.9	3.500	83500
	4		102	4.000	8400
	4	4 1/2	114	4.500	8450
H9		5	127	5.000	8500
		5	127	5.000	9500
		5 1/4	133	5.250	9525
	5		141	5.563	95563
H10		6	152	6.000	9600
	6		168	6.625	96625
		6	168	6.625	06625
		7	178	7.000	0700
		8	203	8.000	0800
	8		219	8.625	08625

Heavy Series Pipe Clamps

Ordering Examples

Single Clamp for Weld Mounting

SH



- Consists of:**
- 2 HEX bolts
 - 1 SCP Cover Plate
 - 1 CLH Clamp Set (2 halves)
 - 1 SWP Weld Plate

Double Clamp for Weld Mounting

DH



- Consists of:**
- 4 HEX bolts
 - 1 DCP Double Cover Plate
 - 2 CLH Clamp Sets (4 halves)
 - 1 DWP Double Weld Plate

Rail Mounting [groups H3-H6]

R7H
R8H



- Consists of:**
- 2 HEX bolts
 - 1 SCP Cover Plate
 - 1 CLH Clamp Set (2 halves)
 - 2 RCN Rail Nuts
 - groups H3-H5 use RCN-7
 - group H6 uses RCN-8

Rail Mounting [group H7]

R9H



- Consists of:**
- 2 HEX bolts
 - 1 SCP Cover Plate
 - 1 CLH Clamp Set (2 halves)
 - 1 SPL Spacer Plate
 - 2 RCN-9 Rail Nuts

Stacking kit

HSK



- Consists of:**
- 2 STB Stacking bolts
 - 1 SAF Safety Plate
 - 1 CLH Clamp Set (2 halves)

Strut Mounting [groups H3-H6]

UH



- Consists of:**
- 2 HEX bolts
 - 1 SCP Cover Plate
 - 1 CLH Clamp Set (2 halves)
 - 2 UCN Strut Nuts

Heavy Series Pipe Clamps

Complete Assembly Dimensions

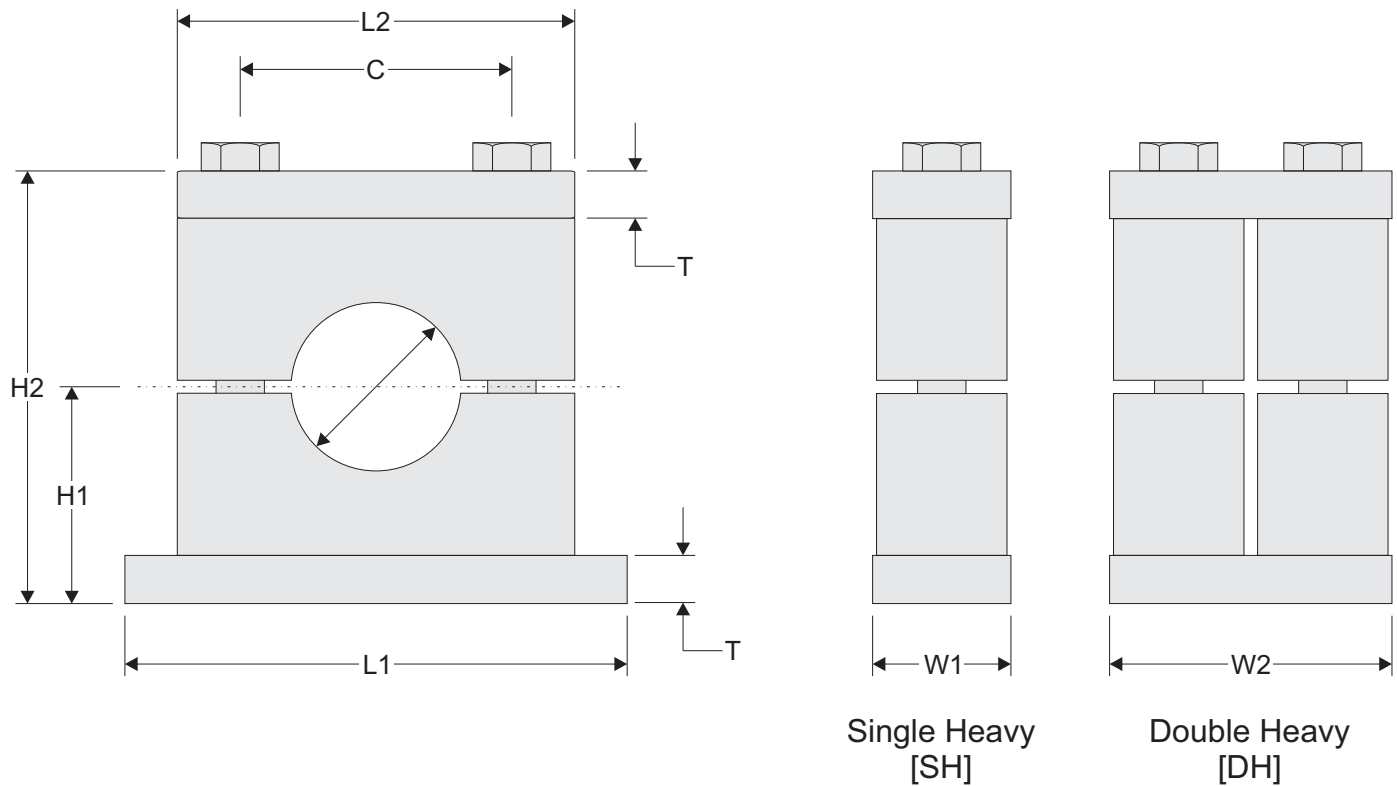

Clamp Assembly Dimensions

Behringer Group	OD	L1	L2	C	H1	H2	T	W1	W2
H3	See ordering code on page 13 for available diameters.	2.875 in. (73 mm)	2.250 in. (57 mm)	1.300 in. (33 mm)	1.000 in. (25.4 mm)	2.000 in. (50.8 mm)	0.313 in. (8 mm)	1.250 in. (32 mm)	2.500 in. (63.5 mm)
H4		3.375 in. (86 mm)	2.750 in. (70 mm)	1.770 in. (45 mm)	1.250 in. (32 mm)	2.500 in. (63.5 mm)	0.313 in. (8 mm)	1.250 in. (32 mm)	2.500 in. (63.5 mm)
H5		4.000 in. (102 mm)	3.344 in. (85 mm)	2.360 in. (60 mm)	1.500 in. (38 mm)	3.000 in. (76.2 mm)	0.313 in. (8 mm)	1.250 in. (32 mm)	2.500 in. (63.5 mm)
H6		5.875 in. (149 mm)	4.500 in. (114 mm)	3.530 in. (90 mm)	2.125 in. (54 mm)	4.250 in. (108 mm)	0.375 in. (10 mm)	1.750 in. (44.5 mm)	3.500 in. (88.9 mm)
H7		7.375 in. (187 mm)	6.000 in. (152 mm)	4.810 in. (122 mm)	2.750 in. (70 mm)	5.500 in. (140 mm)	0.375 in. (10 mm)	2.250 in. (57.2 mm)	4.500 in. (114 mm)
H8		10.000 in. (254 mm)	8.063 in. (205 mm)	6.620 in. (168 mm)	3.813 in. (97 mm)	7.625 in. (194 mm)	0.500 in. (13 mm)	3.000 in. (76.2 mm)	7.000 in. (178 mm)
H9		11.750 in. (298 mm)	9.750 in. (248 mm)	8.060 in. (205 mm)	4.438 in. (113 mm)	8.875 in. (225 mm)	0.500 in. (13 mm)	3.500 in. (88.9 mm)	7.000 in. (178 mm)
H10		14.500 in. (368 mm)	12.500 in. (318 mm)	10.430 in. (265 mm)	6.063 in. (154 mm)	12.125 in. (308 mm)	.750 in. (19 mm)	4.500 in. (114 mm)	9.375 in. (238 mm)