

The Premium Pump

LKH Centrifugal Pump

Applications

The LKH pump is a highly efficient and economical centrifugal pump, which meets the requirements of sanitary and gentle product treatment and chemical resistance.

LKH is available in the following sizes, LKH-5, -10, -15, -20, -25, -35, -40, -45, -50, -60, -70, -75, and -90

Standard design

LKH series is designed to deliver safe and hygienic products with fast and economic cleaning to accommodate 3A requirements.

Shaft seals

The LKH pump is equipped with either an external single or a flushed shaft seal. Both have stationary seal rings made from acid-resistant SS steel, AISI 329. The pump may also be equipped with a double mechanical shaft seal. The static seal face is silicon carbide and the rotary seal face is carbon as standard and optional silicon carbide. The flush seal has a secondary, long life, lip seal.



TECHNICAL DATA

Materials

Product wetted steel parts: Acid-resistant steel AISI 316L and AISI 329.

Other steel parts: Stainless steel AISI 304.

Finish, product wetted surface: Polished •32Ra. and 3A approved.

Product wetted elastomers, std: EPDM rubber.

Optional NBR, FPM, FEP.

Single seal SSS Sic/c or sic/sic.

Double seal DMSS: Primary sic/c or sic/sic.

Double seal DMSS: Secondary sic/c.

Noise level (at 3.3 ft.): 60 - 85 dB (A).

Connections for FSS and DMSS:

R 1/8" (BSP) male thread

Motor

Standard C-faced, foot mounted motor according to NEMA standard. 3500 RPM or 1750 RPM. Premium efficiency, Class F. Note different frame sizes.

LKH-75 and -90 only low speed (1750 RPM).

Voltage and frequency

3 phase, 60 HZ, 230/460V standard. Other voltages and frequencies available upon request.

OPERATING DATA

Pressure

Max. inlet pressure (dynamic)

LKH-5 87 PSI

LKH-10 - LKH-60 145 PSI

LKH-70 - LKH-90 72.52 PSI

Temperature

Temperature range 14°F to +284° F (EPDM)

Flushed shaft seal:

Water pressure inlet: Max. 14.5 PSI.

Water consumption: 4-8 usgph

Double mechanical shaft seal:

Water pressure inlet, LKH-5 to -60: Max. 72.5 PSI.

Water pressure inlet, LKH-70 to -90: Max. 43.5 PSI.

Water consumption: 4-8 usgph

Dimensions (in)

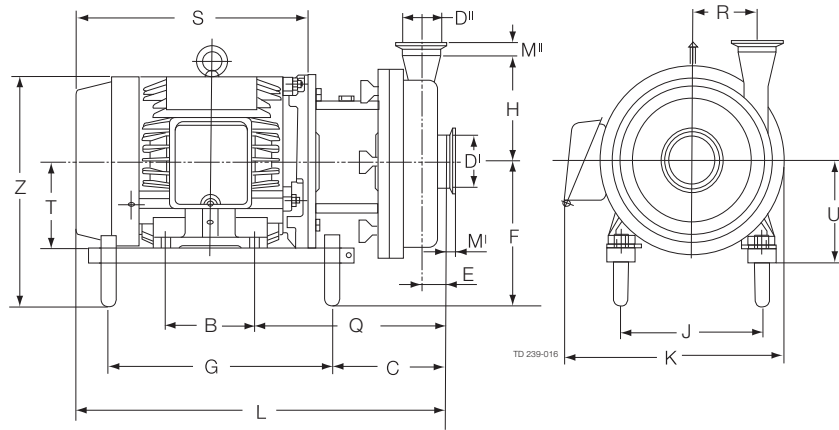

LKH-5 (3600 rpm)

Size	Motor-Sterling					
	1Hp	1.5HP	2Hp	3Hp	5Hp	
B	5.00	5.00	5.00	5.50	5.50	
C	6.42	6.42	6.42	7.64	7.64	
E	0.87	0.87	0.87	0.87	0.87	
F	6.18	6.18	6.18	7.18	7.18	
G	9.38	9.38	9.38	12.50	12.50	
H	6.22	6.22	6.22	6.22	6.22	
J	5.51	5.51	5.51	7.48	7.48	
Q	9.80	9.80	9.80	11.14	11.14	
R	2.76	2.76	2.76	2.76	2.76	
S	10.32	10.32	11.46	12.75	13.34	
T	3.50	3.50	3.50	4.50	4.50	
U	4.00	4.00	4.00	5.00	5.00	
Z	9.68	9.68	9.68	11.40	11.40	
K	10.00	10.00	10.00	11.22	11.22	
L	17.24	17.24	18.38	20.90	21.49	
Weight (lbs)	69.00	79.90	79.90	99.90	-	

LKH-10 (3600 rpm)

Size	Motor-Sterling						
	1Hp	1.5HP	2Hp	3Hp	5Hp	7.5Hp	10Hp
B	5.00	5.00	5.00	5.50	5.50	5.50	5.50
C	6.04	6.04	6.04	7.28	7.28	8.81	8.81
E	0.91	0.91	0.91	0.91	0.91	0.91	0.91
F	6.18	6.18	6.18	7.18	7.18	7.93	7.93
G	9.38	9.38	9.38	12.50	12.50	14.00	14.00
H	5.79	5.79	5.79	5.79	5.79	5.79	5.79
J	5.51	5.51	5.51	7.48	7.48	8.50	8.50
Q	9.42	9.42	9.42	10.78	10.78	12.31	12.31
R	3.43	3.43	3.43	3.43	3.43	3.43	3.43
S	10.32	10.32	11.46	12.75	13.34	14.03	15.25
T	3.50	3.50	3.50	4.50	4.50	5.25	5.25
U	4.00	4.00	4.00	5.00	5.00	5.75	5.75
Z	9.68	9.68	9.68	11.40	11.40	13.31	13.31
K	10.39	10.39	10.39	11.32	11.32	13.02	13.02
L	16.86	16.86	18.00	20.53	21.12	23.56	24.78
Weight (lbs)	81.00	89.00	91.00	111.00	128.00	179.00	204.00



CSI

CONTACT CSI FOR MORE INFORMATION | CSIDESIGNS.COM | SALES@CSIDESIGNS.COM | 417.831.1411

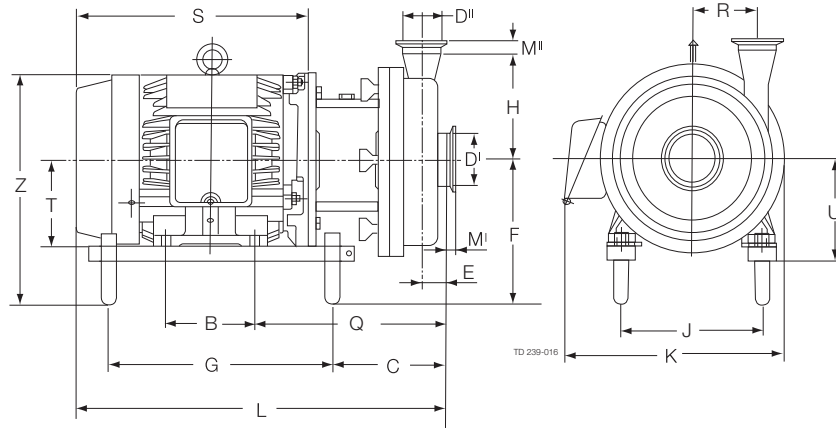

LKH-15 (3600 rpm)

Size	Motor-Sterling						
	2Hp	3Hp	5Hp	7.5Hp	10Hp	15Hp	
B	5.00	5.50	5.50	5.50	5.50	8.25	
C	7.17	8.66	8.66	10.20	10.20	12.72	
E	1.69	1.69	1.69	1.69	1.69	1.69	
F	6.18	7.18	7.18	7.93	7.93	8.93	
G	9.38	12.50	12.50	14.00	14.00	14.50	
H	6.54	6.54	6.54	6.54	6.54	6.54	
J	5.51	7.48	7.48	8.50	8.50	10.00	
Q	10.55	12.17	12.17	13.70	13.70	14.96	
R	2.60	2.60	2.60	2.60	2.60	2.60	
S	11.46	12.75	13.34	14.03	15.25	19.40	
T	3.50	4.50	4.50	5.25	5.25	6.25	
U	4.00	5.00	5.00	5.75	5.75	6.75	
Z	9.68	11.40	11.40	13.31	13.31	15.33	
K	10.39	11.54	11.54	13.00	13.00	17.30	
L	19.13	21.93	22.52	24.96	26.18	29.96	
Weight (lbs)	98.00	118.00	135.00	186.00	211.00	304.00	

Dimensions (in)

LKH-20 (3600 rpm)

Size	Motor-Sterling						
	2Hp	3Hp	5Hp	7.5Hp	10Hp	15Hp	20Hp
B	5.00	5.50	5.50	5.50	5.50	8.25	8.25
C	6.52	7.75	7.75	9.28	9.28	11.78	11.78
E	1.06	1.06	1.06	1.06	1.06	1.06	1.06
F	6.18	7.18	7.18	7.93	7.93	8.93	8.93
G	9.38	12.50	12.50	14.00	14.00	14.50	14.50
H	7.09	7.09	7.09	7.09	7.09	7.09	7.09
J	5.51	7.48	7.48	8.50	8.50	10.00	10.00
Q	9.90	11.25	11.25	12.78	12.78	14.03	14.03
R	3.46	3.46	3.46	3.46	3.46	3.46	3.46
S	11.46	12.75	13.34	14.03	15.25	19.40	21.10
T	3.50	4.50	4.50	5.25	5.25	6.25	6.25
U	4.00	5.00	5.00	5.75	5.75	6.75	6.75
Z	9.68	11.40	11.40	13.31	13.31	15.33	15.33
K	10.51	11.44	11.44	13.02	13.02	17.30	17.30
L	18.48	21.00	21.59	24.03	25.25	29.03	30.73
Weight (lbs)	95.00	115.00	132.00	183.00	208.00	301.00	-



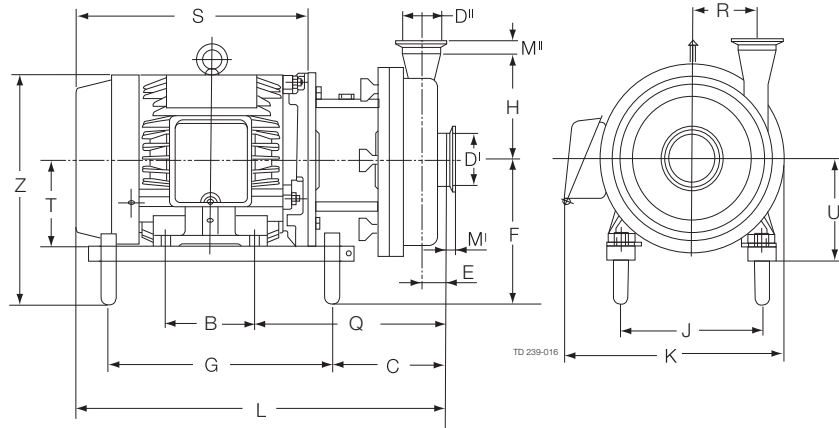

LKH-25 (3600 rpm)

Size	Motor-Sterling							
	3Hp	5Hp	7.5Hp	10Hp	15Hp	20Hp	25Hp	30Hp
B	5.50	5.50	5.50	5.50	8.25	8.25	10.00	10.00
C	7.96	7.96	9.49	9.49	12.00	12.00	12.46	12.46
E	1.26	1.26	1.26	1.26	1.26	1.26	1.26	1.26
F	7.18	7.18	7.93	7.93	8.93	8.93	9.68	9.68
G	12.50	12.50	14.00	14.00	14.50	14.50	15.51	15.51
H	7.60	7.60	7.60	7.60	7.60	7.60	7.60	7.60
J	7.48	7.48	8.50	8.50	10.00	10.00	11.00	11.00
Q	11.47	11.47	12.99	12.99	14.24	14.24	14.70	14.70
R	4.17	4.17	4.17	4.17	4.17	4.17	4.17	4.17
S	12.75	13.34	14.03	15.25	19.40	21.10	22.28	23.78
T	4.50	4.50	5.25	5.25	6.25	6.25	7.00	7.00
U	5.00	5.00	5.75	5.75	6.75	6.75	7.50	7.50
Z	11.40	11.40	13.31	13.31	15.33	15.33	17.51	17.51
K	12.42	12.42	13.61	13.61	17.30	17.30	21.24	21.24
L	21.22	21.81	24.25	25.47	29.25	30.95	32.13	33.63
Weight (lbs)	125.00	142.00	193.00	218.00	311.00	361.00	442.00	473.00

LKH-35 (3600 rpm)

Size	Motor-Sterling							
	3Hp	5Hp	7.5Hp	10Hp	15Hp	20Hp	25Hp	30Hp
B	5.50	5.50	5.50	5.50	8.25	8.25	10.00	10.00
C	7.37	7.37	8.90	8.90	11.41	11.41	11.87	11.87
E	0.91	0.91	0.91	0.91	0.91	0.91	0.91	0.91
F	7.18	7.18	7.93	7.93	8.93	8.93	9.68	9.68
G	12.50	12.50	14.00	14.00	14.50	14.50	15.51	15.51
H	7.60	7.60	7.60	7.60	7.60	7.60	7.60	7.60
J	7.48	7.48	8.50	8.50	10.00	10.00	11.00	11.00
Q	10.88	10.88	12.41	12.41	13.65	13.65	14.11	14.11
R	4.69	4.69	4.69	4.69	4.69	4.69	4.69	4.69
S	12.75	13.34	14.03	15.25	19.40	21.10	22.28	23.78
T	4.50	4.50	5.25	5.25	6.25	6.25	7.00	7.00
U	5.00	5.00	5.75	5.75	6.75	6.75	7.50	7.50
Z	11.40	11.40	13.31	13.31	15.33	15.33	17.51	17.51
K	12.42	12.42	13.60	13.60	17.30	17.30	21.24	21.24
L	20.63	21.22	23.66	24.88	28.66	30.36	31.54	33.04
Weight (lbs)	121.00	138.00	189.00	214.00	307.00	357.00	438.00	469.00



Dimensions (in)

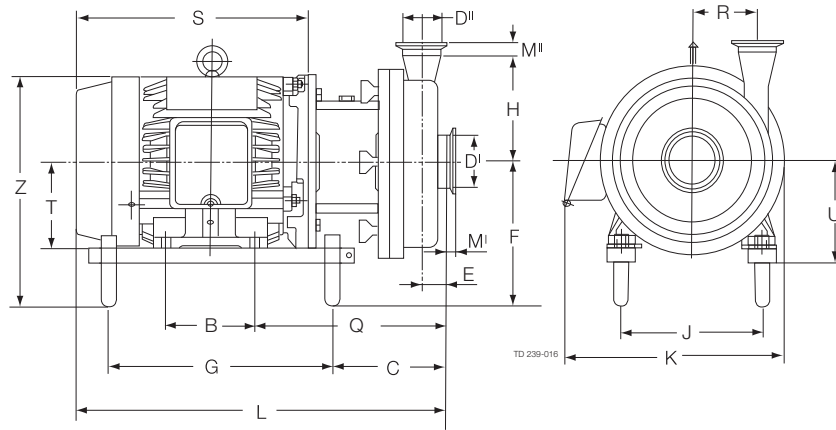

LKH-40 (3600 rpm)

Size	Motor-Sterling							
	3Hp	5Hp	7.5Hp	10Hp	15Hp	20Hp	25Hp	30Hp
B	5.50	5.50	5.50	5.50	8.25	8.25	10.00	10.00
C	7.79	7.79	9.32	9.32	11.82	11.82	12.28	12.28
E	1.10	1.10	1.10	1.10	1.10	1.10	1.10	1.10
F	7.18	7.18	7.93	7.93	8.93	8.93	9.68	9.68
G	12.50	12.50	14.00	14.00	14.50	14.50	15.51	15.51
H	8.35	8.35	8.35	8.35	8.35	8.35	8.35	8.35
J	7.48	7.48	8.50	8.50	10.00	10.00	11.00	11.00
Q	11.29	11.29	12.82	12.82	14.07	14.07	14.53	14.53
R	4.96	4.96	4.96	4.96	4.96	4.96	4.96	4.96
S	12.75	13.34	14.03	15.25	19.40	21.10	22.28	23.78
T	4.50	4.50	5.25	5.25	6.25	6.25	7.00	7.00
U	5.00	5.00	5.75	5.75	6.75	6.75	7.50	7.50
Z	11.40	11.40	13.31	13.31	15.33	15.33	17.51	17.51
K	12.95	12.95	14.12	14.12	17.30	17.30	21.24	21.24
L	21.04	21.63	24.07	25.29	29.07	30.77	31.95	33.45
Weight (lbs)	130.00	147.00	198.00	223.00	316.00	366.00	447.00	487.00

LKH-45 (3600 rpm)

Size	Motor-Sterling							
	3Hp	5Hp	7.5Hp	10Hp	15Hp	20Hp	25Hp	30Hp
B	5.50	5.50	5.50	5.50	8.25	8.25	10.00	10.00
C	8.52	8.52	10.05	10.05	12.55	12.55	13.01	13.01
E	1.59	1.59	1.59	1.59	1.59	1.59	1.59	1.59
F	7.18	7.18	7.93	7.93	8.93	8.93	9.68	9.68
G	12.50	12.50	14.00	14.00	14.50	14.50	15.51	15.51
H	7.60	7.60	7.60	7.60	7.60	7.60	7.60	7.60
J	7.48	7.48	8.50	8.50	10.00	10.00	11.00	11.00
Q	12.02	12.02	13.55	13.55	14.49	14.49	15.25	15.25
R	3.88	3.88	3.88	3.88	3.88	3.88	3.88	3.88
S	12.75	13.34	14.03	15.25	19.40	21.10	22.28	23.78
T	4.50	4.50	5.25	5.25	6.25	6.25	7.00	7.00
U	5.00	5.00	5.75	5.75	6.75	6.75	7.50	7.50
Z	11.40	11.40	13.31	13.31	15.33	15.33	17.51	17.51
K	12.42	12.42	13.60	13.60	17.30	17.30	21.24	21.24
L	21.77	22.36	24.80	26.02	29.80	31.50	32.68	34.18
Weight (lbs)	127.00	144.00	195.00	220.00	313.00	363.00	444.00	475.00



Dimensions (in)

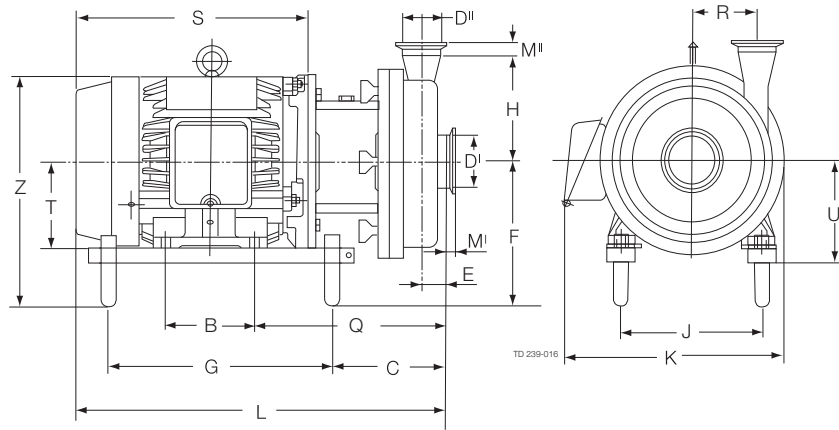

LKH-50 (3600 rpm)

Size	Motor-Sterling							
	3Hp	5Hp	7.5Hp	10Hp	15Hp	20Hp	25Hp	30Hp
B	5.50	5.50	5.50	5.50	8.25	8.25	10.00	10.00
C	8.29	8.29	9.82	9.82	12.32	12.32	12.78	12.78
E	1.38	1.38	1.38	1.38	1.38	1.38	1.38	1.38
F	7.18	7.18	7.93	7.93	8.93	8.93	9.68	9.68
G	12.50	12.50	14.00	14.00	14.50	14.50	15.51	15.51
H	8.07	8.07	8.07	8.07	8.07	8.07	8.07	8.07
J	7.48	7.48	8.50	8.50	10.00	10.00	11.00	11.00
Q	11.79	11.79	13.32	13.32	14.57	14.57	15.03	15.03
R	4.65	4.65	4.65	4.65	4.65	4.65	4.65	4.65
S	12.75	13.34	14.03	15.25	19.40	21.10	22.28	23.78
T	4.50	4.50	5.25	5.25	6.25	6.25	7.00	7.00
U	5.00	5.00	5.75	5.75	6.75	6.75	7.50	7.50
Z	11.40	11.40	13.31	13.31	15.33	15.33	17.51	17.51
K	12.95	12.95	14.12	14.12	17.30	17.30	21.24	21.24
L	21.54	22.13	24.57	25.79	29.57	31.27	32.45	33.95
Weight (lbs)	130.00	147.00	198.00	223.00	316.00	366.00	447.00	487.00

LKH-60 (3600 rpm)

Size	Motor-Sterling							
	7.5Hp	10Hp	15Hp	20Hp	25Hp	30Hp	40Hp	50Hp
B	5.50	5.50	8.25	8.25	10.00	10.00	10.50	10.50
C 4x4	10.96	10.96	13.47	13.47	13.93	13.95	10.55	10.55
C 6x4	12.55	12.55	15.05	15.05	15.51	15.51	12.14	12.14
E 4x4	2.66	2.66	2.66	2.66	2.66	2.66	2.66	2.66
E 6x4	4.25	4.25	4.25	4.25	4.25	4.25	4.25	4.25
F	7.93	7.93	8.93	8.93	9.68	9.68	11.23	11.23
G	14.00	14.00	14.50	14.50	15.51	15.51	21.00	21.00
H	10.29	10.29	10.29	10.29	10.29	10.29	10.29	10.29
J	8.50	8.50	10.00	10.00	11.00	11.00	12.50	12.50
Q 4x4	14.46	14.46	15.71	15.71	16.17	16.17	16.57	16.57
Q 6x4	16.05	16.05	17.29	17.29	17.75	17.75	18.15	18.15
R	3.95	3.95	3.95	3.95	3.95	3.95	3.95	3.95
S	14.03	15.25	19.40	21.10	22.28	23.78	24.57	24.07
T	5.25	5.25	6.25	6.25	7.00	7.00	8.00	8.00
U	5.75	5.75	6.75	6.75	7.50	7.50	8.79	8.79
Z	13.31	13.31	15.33	15.33	17.51	17.51	19.89	19.89
K	14.12	14.12	17.30	17.30	21.24	21.24	23.03	23.03
L 4x4	24.24	25.46	30.72	32.42	33.60	35.10	35.89	35.39
L 6x4	25.83	27.05	32.30	34.00	35.18	36.68	37.47	36.97
Weight (lbs)	209.00	228.00	321.00	371.00	452.00	483.00		



Dimensions (in)

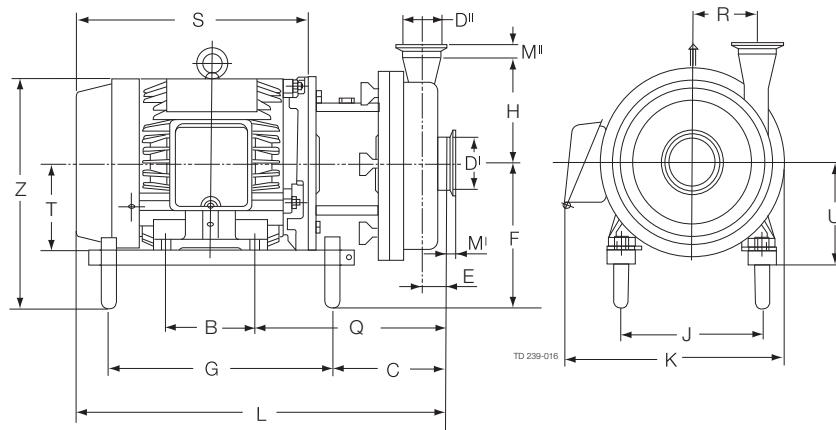

LKH-70 (3600 rpm)

Size	Motor-Sterling									
	15Hp	20Hp	25Hp	30Hp	40Hp	50Hp	60Hp	75Hp	100Hp	
B	8.25	10.00	9.50	11.00	10.50	12.00	11.25	12.25	13.75	
C	11.87	11.87	12.38	12.38	12.13	12.13	12.13	12.13	12.87	
E	0.98	0.98	0.98	0.98	0.98	0.98	0.98	0.98	0.98	
F	7.88	7.88	8.63	8.63	12.92	12.92	13.92	13.92	14.92	
G	14.50	14.50	15.50	15.50	21.00	21.00	21.00	21.00	21.00	
H	10.00	10.00	10.00	10.00	10.00	10.00	10.00	10.00	10.00	
J	10.00	10.00	11.00	11.00	12.50	12.50	14.00	14.00	16.00	
Q	14.13	14.13	14.62	14.62	15.13	15.13	15.75	15.75	16.50	
R	5.79	5.79	5.79	5.79	5.79	5.79	5.79	5.79	5.79	
S	19.4	21.1	22.27	23.77	24.45	26.07	26.67	27.65	33.87	
T	6.25	6.25	7.00	7.00	8.00	8.00	9.00	9.00	10.00	
U	6.88	6.88	7.63	7.63	8.79	8.79	9.79	9.79	10.79	
Z	14.14	14.14	16.6	16.6	20.67	20.67	23.17	23.17	24.53	
K	18.53	18.53	19.91	19.91	21.03	21.03	22.03	22.03	24.03	
L	29.28	30.98	32.14	33.64	34.34	35.95	36.54	37.52	43.75	
Weight (lbs)	-	-	-	-	-	-	-	-	-	

LKH-75 (1800 rpm)

Size	Motor-Sterling					
	15Hp	20Hp	25Hp	30Hp	40Hp	50Hp
B	8.25	10.00	9.50	11.00	10.50	12.00
C	10.96	12.71	11.71	13.21	9.94	9.94
E	2.42	2.42	2.42	2.42	2.42	2.42
F	7.88	7.88	8.63	8.63	12.92	12.92
G	14.50	14.50	15.50	15.50	21.00	21.00
H	12.80	12.80	12.80	12.80	12.80	12.80
J	10.00	10.00	11.00	11.00	12.50	12.50
Q	14.96	14.96	15.46	15.46	15.96	16.59
R	9.84	9.84	9.84	9.84	9.84	9.84
S	19.4	21.1	22.27	23.77	24.45	26.07
T	6.25	6.25	7.00	7.00	8.00	8.00
U	6.88	6.88	7.63	7.63	8.79	8.79
Z	14.14	14.14	16.6	16.6	20.67	20.67
K	20.01	20.01	22.61	22.61	23.58	23.58
L	30.11	31.81	32.98	34.48	35.17	37.41
Weight (lbs)	-	-	-	-	-	-



Dimensions (in)
(900315/0)

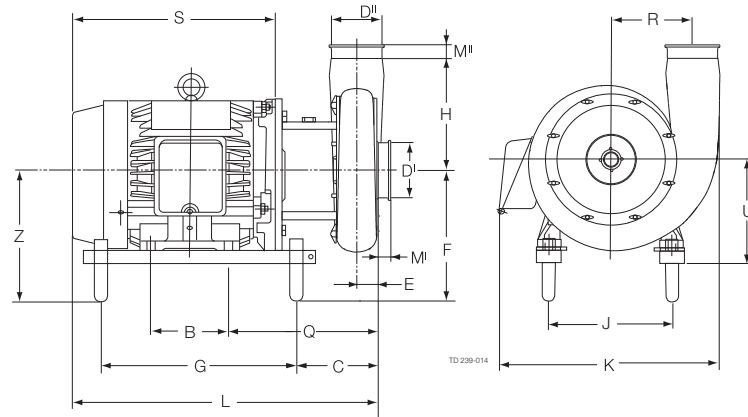

LKH-90 (1800 rpm)

Size	Motor-Sterling					
	30Hp	40Hp	50Hp	60Hp	75Hp	100Hp
B	11.00	10.50	12.00	11.25	12.25	13.75
C	9.37	9.86	9.86	12.88	12.88	13.87
E	2.56	2.56	2.56	2.56	2.56	2.56
F	11.92	12.92	12.92	13.92	13.92	14.92
G	15.50	21.00	21.00	21.00	21.00	21.00
H	12.20	12.20	12.20	12.20	12.20	12.20
J	11.00	12.50	12.50	14.00	14.00	16.00
Q	15.37	15.87	15.87	16.50	16.50	17.49
R	9.84	9.84	9.84	9.84	9.84	9.84
S	23.77	24.45	26.07	26.67	27.65	33.87
T	7.00	8.00	8.00	9.00	9.00	10.00
U	8.38	8.79	8.79	9.79	9.79	10.79
Z	19.89	20.89	20.89	23.17	23.17	24.53
K	26.16	27.48	27.48	30.44	30.44	33.99
L	34.39	35.08	36.69	37.29	38.27	44.74
Weight (lbs)	939	974	1084	1236	1424	1497

Inlet/Outlet Connections - Tri-Clamp® (inches)

Refer to dimensional drawings

	LKH-5	LKH-10, -20 LKH-35	LKH-25	LKH-40	LKH-15, -45 LKH-50,-70	LKH-60,-75	LKH-60, -70*	LKH-90
D ^I	2.00	2.50	3.00	3.00	4.00	4.00	6.00	6.00
D ^{II}	1.50	2.00	2.50	2.00	3.00	4.00	4.00	6.00
M ^I	1.13	1.13	1.13	1.13	1.13	1.13	1.50	1.5
M ^{II}	1.13	1.13	1.13	1.13	1.13	1.13	1.13	1.5

*= LKH-60, 70 are with reducer on D^I



Technical Data

Volumetric Flow

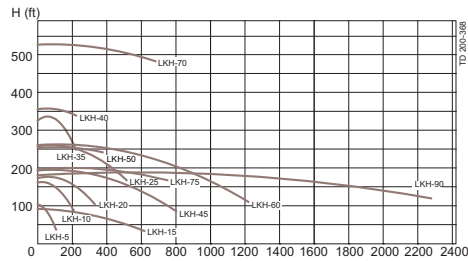

Options

- A. Impeller with reduced diameter.
- B. Motor enclosures: washdown, TEFC, explosion proof, inverter duty and others upon request.
- C. Inducer (only LKH-10 to -50).
- D. Flushed shaft seal.
- E. Double mechanical shaft seal.
- F. Counter flanges, seal rings and bolts for flanged connections (industrial version).
- G. Standard clearance is 0.02" (0.04" for LKH-70 to LKH-90) and can be made up to 0.098").

Material grades

- H. Product wetted seals of Buna (NBR), Fluoroelastomer (FPM) or FEP.
- I. Rotating seal ring of silicon carbide.

Ordering

Please state the following when ordering:

- Pump size.
- Version, sanitary or industrial.
- Connections.
- Seal and Elastomer Type
- Impeller diameter.
- Motor size.
- Voltage and frequency.
- Flow, pressure and temperature.
- Density and viscosity of the product.
- Options.