

Hygienic Pumps

GEA Hilge CONTRA I/II BLOC

Operating instruction (Translation from the original language)
BA.10A.BYY.001.GB_3

COPYRIGHT

All rights reserved.

Nothing contained in this documentation may be reproduced or distributed in any form (print, photocopy, microfilm or another method) without the prior written permission of

GEA Hilge

Niederlassung der GEA Tuchenhagen GmbH

hereinafter referred to as **Manufacturer** This restriction also applies to the drawings and diagrams included in the documentation.

LEGAL NOTICE

These instructions are part of the technical documentation, which is part of the scope of delivery. They contain important information to ensure safe and proper transportation, mounting, commissioning, economic operation, maintenance, and repair of the pump. Following these instructions will help you avoid risks, reduce repair costs and downtime and increase the pump's reliability and service life.

These instructions are aimed at users of the pump and are intended in particular for the operator and its operating and maintenance personnel.

It is mandatory for the operator and its operating and maintenance personnel to read these instructions prior to transport, installation, commissioning, use, maintenance, repair, disassembly and disposal of the pump. The obligation to read these instructions applies also to persons responsible for carrying out activities in the phases of the life of the pump.

The operator is required to complement these instructions with information based on existing national regulations for occupational safety, health protection, and environmental protection.

In addition to these instructions and the mandatory regulations for accident prevention applicable in the country and place of use, the recognised technical rules for safe and proper work must be observed.

These instructions are part of the pump. The entire documentation consists of these instructions and any additional instructions provided. It must always be kept within reach at the pump's location of use. When moving the pump to a different site and upon selling the pump, the entire documentation must be passed on as well.

These instructions were written to the best of our conscience. However, the manufacturer is not liable for any errors that may be contained in this document or for any resulting consequences.

The manufacturer reserves the right to make technical changes by further development of the pump described in these instructions.

Illustrations and drawings in these instructions are simplified representations. Due to enhancements and changes, it is possible that the illustrations do not exactly match the pump used by you. The technical data and dimensions are not binding. Claims cannot be derived from them.

The manufacturer assumes no liability for damages

- arising within the warranty period due to

-
- unintended operation and usage conditions,
 - insufficient maintenance,
 - improper operation,
 - incorrect installation,
 - incorrect or improper connection of electrical components.
- resulting or arising from unauthorised modifications or failure to follow the instructions,
 - caused by use of accessories / spare parts that have not been supplied or recommended by the manufacturer.

LAYOUT INFORMATION

Bullet points and numbered list characters

Bullet points are used to separate logical contents within a section:

- Bullet point 1
Types of bullet point 1.
- Bullet point 2
Types of bullet point 2.

Numbered list characters are used to separate enumerations within a descriptive text:

Descriptive text with consecutive numbering:

- Numbered list point 1
- Numbered list point 2

Handling instructions

Handling instructions require you to do something. Several consecutive steps result in a handling sequence that should be run in the specified order. The handling sequence can be divided into separate steps.

Handling sequence

1. Handling sequence step 1
 - step 1,
 - step 2,
 - step 3.

2. Handling sequence step 2

The subsequent handling sequence is the expected result:

→ Result of the handling sequence.

Individual handling steps

Individual handling steps are marked thus:

- Individual work steps

TABLE OF CONTENTS

1	General	7
1.1	Information about this document	7
1.2	Manufacturer address	7
1.3	Customer service	7
1.4	EU Declaration of Conformity for Machines	8
1.5	UKCA - Declaration of Conformity	9
2	Safety	10
2.1	Intended use	10
2.1.1	Pumped fluids	10
2.1.2	Minimum flow rate	10
	Minimum flow rates in explosive atmospheres	10
2.1.3	Connections and piping	10
2.1.4	Switching frequency	10
2.1.5	Types	10
2.2	Safety precautions in these operating instructions	11
2.3	Explanation of the safety symbols used	12
2.4	Safety instructions for the company/operator	12
2.4.1	Dangers of non-compliance with safety information	13
2.4.2	Safety-conscious work behaviour	13
2.5	Unauthorised modification and ordering of spare parts	13
2.6	Staff qualifications and training	14
2.7	Safety equipment	14
2.8	Possible residual hazards	14
3	Description	16
3.1	Pump overview	16
3.2	Description	17
3.2.1	Standard version applications	17
3.2.2	Hygienic design applications	17
3.3	Pump name	17
3.4	Name plate	17
4	Transport and Storage	19
4.1	Special personnel qualification for transport and storage	19
4.2	Safety precautions for transport and storage	19
4.3	Safety instructions for transporting the pump	19
4.4	Attachment points for lifting loads	19
4.5	Storage of the pump	19
4.6	Dimensions / weights	20
4.7	Unpacking the pump	21
4.8	Disposal of packaging material	21
5	Technical data	22
5.1	Serial number	22
5.2	Performance data	22
5.3	Noise emissions	22
5.4	Maximum operating temperatures	23
5.5	Maximum operating pressure	23
5.6	Resistance of Sealing Materials	23
6	Assembly and installation	25
6.1	Safety precautions for setup, installation, and connection	25
6.1.1	Mechanical seals in tandem arrangement and Quench	27
6.1.2	Mechanical seals in back-to-back arrangement	27
6.1.3	Vertically installed pumps	27
6.2	Special personnel qualification	27
6.3	Setup, installation, and connection	27
6.3.1	Checking smooth running of the impeller	28
6.3.2	Setting up and aligning the pump unit	28
6.3.3	Installation in the piping system	29
	Space requirements	29
	Noise and vibration damping	30
6.3.4	Using the mechanical seal	32
6.3.5	Flush connections for double mechanical seals (optional)	33

	Flushing fluid (optional) _____	33
	Double mechanical seals (optional) _____	33
6.3.6	Electrical connection _____	36
	Star connection _____	36
	Delta connection _____	36
	Frequency converter operation _____	37
	Checking the direction of rotation after connecting _____	37
	Earthing _____	38
7	Commissioning _____	39
7.1	Special personnel qualification _____	39
7.2	Safety instructions for commissioning _____	39
7.3	Commissioning / initial startup _____	39
7.3.1	Checking conditions of use _____	39
7.3.2	Vent pump _____	40
7.3.3	Commissioning of the pump _____	40
7.3.4	Functional testing of the mechanical seal _____	41
8	Cleaning _____	42
8.1	Special personnel qualification _____	42
8.2	Safety instructions _____	42
8.3	CIP _____	43
8.4	SIP _____	44
8.5	Manual exterior cleaning _____	44
9	Maintenance / servicing _____	45
9.1	Safety instructions for maintenance and servicing _____	45
9.2	Special personnel qualification _____	45
9.3	Pump maintenance _____	45
9.3.1	Inspections _____	45
	Replacement of O-rings _____	46
9.3.2	Maintenance intervals _____	46
9.4	Maintenance of the motor _____	47
10	Malfunctions / repairs _____	48
10.1	Special personnel qualification _____	48
10.2	Safety instructions _____	48
10.3	Malfunctions and remedies _____	49
10.4	Repair _____	50
10.4.1	Repair order _____	50
10.4.2	GEA Hilge assembly tool kit _____	51
	Contents and use _____	51
10.4.3	Parts overview _____	52
10.4.4	Parts overview for BLOC motor stool _____	53
10.4.5	Parts overview for motor and shroud _____	54
10.4.6	Installation instructions _____	55
	Cleaning the components before assembly _____	55
10.4.7	Installing the BLOC motor stool _____	56
10.4.8	Fasten discharge casing - simple mechanical seal _____	57
10.4.9	Installing single conical spring mechanical seal _____	58
10.4.10	Installing the single mechanical seal - spring encapsulated (hygiene) _____	60
10.4.11	Installing double mechanical seal _____	62
10.4.12	Installing tandem double mechanical seal _____	67
10.4.13	Installing double mechanical seal in back-to-back position _____	69
10.4.14	Installing impeller and housing _____	71
11	Decommissioning _____	78
11.1	Special personnel qualification _____	78
11.2	Safety instructions _____	78
11.3	Temporary decommissioning _____	78
11.4	Disposal _____	78
12	Appendix _____	79
12.1	Certificate of non-objection _____	80

1 General

1.1 Information about this document

Target group

These operating instructions are intended for:

- the operator/user of the pump,
- the maintenance and service personnel.

The instructions assume a general common technical understanding, which is necessary for the commissioning, maintenance and servicing of pump units.

Sections that are aimed only at special authorised personnel are indicated by a preceding note.

Text highlights

The following symbols and text formatting facilitate the reading of this document:

- Bullets and lists points
- Instructions.

Instructions that must be executed in a certain order are numbered according to the sequence.

For the marking of safety instructions, please refer to Section 2.3, Page 12.

Technical changes

Types, technical data and spare part numbers are subject to technical change.

We reserve the right to implement changes due to technical progress.

1.2 Manufacturer address

GEA Hilge
Niederlassung der GEA Tuchenhausen GmbH
Hilgestraße 37-47
55294 Bodenheim
Germany

Phone +49 6135 7016-0
Fax +49 6135 1737
hilge@gea.com
gea.com

1.3 Customer service

Phone +49 6135 7016 100 (Sales support)
Phone +49 6135 7016101 (Service)
spareparts.hilge@gea.com

General

EU Declaration of Conformity for Machines

1.4 EU Declaration of Conformity for Machines
in accordance with the EC Machinery Directive 2006/42/EC, Annex II 1. A

Manufacturer: **GEA HILGE**
Niederlassung der GEA Tuchenhagen GmbH
Hilgestrasse 37-47
D 55294 Bodenheim Germany

We declare under our sole responsibility that the machine

Designation: Centrifugal pump
Model / type: GEA Hilge CONTRA I ADAPTA, ADAPTA-SUPER
GEA Hilge CONTRA II ADAPTA, ADAPTA-SUPER
GEA Hilge CONTRA III ADAPTA, ADAPTA-SUPER
GEA Hilge CONTRA I BLOC, BLOC-SUPER
GEA Hilge CONTRA II BLOC, BLOC-SUPER

conforms with all the relevant provisions of this directive and the following directives:

Relevant EC directives: 2006/42/EC EC Machinery Directive

Applicable harmonized standards, in particular: EN 809:1998/A1+AC(D)

EN ISO 12100:2010

Remarks: We also declare that the relevant technical documentation for this machine has been prepared in accordance with Annex VII, Part A, and agree to submit the documentation on justified request of national authorities on a data carrier.

Person authorised for compilation and handover of technical documentation: **GEA HILGE**
Niederlassung der GEA Tuchenhagen GmbH
Hilgestrasse 37-47
55294 Bodenheim Germany

Bodenheim, 10.11.2022

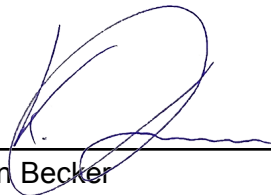

Karsten Becker
Managing Director



pp. Dr. Danijel Anciger
Manager Product Development

1.5 UKCA - Declaration of Conformity

We,

GEA HILGE
Niederlassung der GEA Tuchenhagen GmbH
Hilgestrasse 37-47
D 55294 Bodenheim Germany

hereby declare that the machine

Designation: Centrifugal pump
Model / type: GEA Hilge CONTRA I ADAPTA, ADAPTA-SUPER
GEA Hilge CONTRA II ADAPTA, ADAPTA-SUPER
GEA Hilge CONTRA III ADAPTA, ADAPTA-SUPER
GEA Hilge CONTRA I BLOC, BLOC-SUPER
GEA Hilge CONTRA II BLOC, BLOC-SUPER

complies with the following UK directives, provided that the conditions for commissioning are fulfilled as specified in the technical documentation, in particular in the operating manual:

Supply of Machinery (Safety) Regulations 2008, 2008 No. 1597

Applicable harmonized standards: EN 809:1998+A1:2009+AC(D)
EN ISO 12100:2010

Person authorised for compilation and handover of technical documentation: **GEA Mechanical Equipment UK Ltd**
Westfalia House
Old Wolverton Road, Old Wolverton, Milton Keynes
MK12 5PY, United Kingdom

Bodenheim, 10.11.2022



Karsten Becker
Managing Director



pp. Dr. Danijel Anciger
Manager Product Development

2 Safety

2.1 Intended use

Warning!

Non-intended use!

- ▶ Pump only media that are specified in the order. The pump has been specially designed for them.
 - ▶ Operate the pump only on the electrical grid that was specified in the purchase order.
-

2.1.1 Pumped fluids

Use only clean or lightly polluted liquids as pumped fluids as long as they do not chemically or mechanically attack the pump materials or reduce their strength. If you want to pump liquids with higher viscosity than that of water, check for possible overload of the motor.

2.1.2 Minimum flow rate

The pump may not be operated below of a flow rate of $Q_{\min} = 10-15 \% Q_{\text{opt}}$.

2.1.2.1 Minimum flow rates in explosive atmospheres

For pumps used in explosive atmospheres according to EU Explosion Protection Directive 2014/34/EU or according to the Regulation on Equipment and Protective Systems intended for use in Potentially Explosive Atmospheres 2016, the minimum flow rates of the ATEX Supplementary Operating Manual in Appendix B apply.

2.1.3 Connections and piping

The pipe nominal diameters of the system should be equal to or greater than the pump nominal diameters DNE (suction side) or DNA (pressure side), and the fittings to the pump should match exactly the type standard of the fixed mating connection part on the pump. The suction line must be hermetically sealed and routed such that no air pockets can form. Avoid tight bends and valves directly in front of the pump. On the suction side, a straight settling section with a minimum length of 5 times the pipe diameter should be provided. The suction head of the system must not be larger than the suction head guaranteed by the pump.

2.1.4 Switching frequency

Do not exceed a switching frequency of 15 switching operations per hour.

2.1.5 Types

All information and descriptions in these operating instructions on the use and handling of the pumps refer exclusively to the standard versions. Special designs and customised deviations as well as random external influences in the use and operation are not included in these instructions.

2.2 Safety precautions in these operating instructions

Read the safety precautions!

These operating instructions contain basic precautions that must be observed during installation, operation and maintenance. They must therefore be read by the installer and relevant personnel or operator prior to installation and commissioning. The operating instructions must always be available at machine/system site.

In addition to the general safety precautions listed in this chapter on safety, be sure to read also the other, special safety precautions included.

2.3 Explanation of the safety symbols used



Danger

Stands for an immediate danger which leads to heavy physical injuries or to the death.

- ▶ Description to avert the danger
-



Warning!

Stands for a possibly dangerous situation which leads to heavy physical injuries or to the death.

- ▶ Description to avert the dangerous situation.
-



Caution!

Stands for a possibly dangerous situation which could lead to light physical injuries or to damages to property.

- ▶ Description to avert the dangerous situation.
-

Notice

Stands for an important tip whose attention is important for the designated use and function of the product.

- ▶ Description of the necessary action for proper operation of the product.
-

2.4 Safety instructions for the company/operator

Follow the safety instructions contained in this operating manual, the relevant national accident prevention regulations as well as any internal working, operating, and safety provisions of the operating company.



Warning!

Hot or cold machine parts

Risk of burns.

- ▶ Secure hot or cold machine parts against contact!
-



Warning!

Rotating machine parts

Hazard of entrapment or entanglement.

- ▶ Do not remove contact protection for rotating machine parts (e.g. coupling)!
 - ▶ Replace defective safety devices promptly!
-

 Warning!**Hazardous materials**

Contact with dangerous substances, e.g. by inhalation.

- ▶ Discharge the leakage of dangerous goods such that no danger to persons and the environment arises!
 - ▶ Comply with legal provisions!
 - ▶ Switch off the pump in the event of failure of the mechanical seal. Replace the mechanical seal before next use!
-

 Warning!**Tripping and falling hazard**

Danger due to electrical cables.

- ▶ Route the electrical supply line such that there is no risk of tripping (only for pumps on a chassis).
-

 Danger**Live parts**

Electric shock by touching live parts

- ▶ Use only technically flawless plugs and cables.
-

2.4.1 Dangers of non-compliance with safety information

Ignoring the safety instructions can result in bodily harm to persons as well as environmental harm and machine damage.

Failure to follow the safety instructions will result in the loss of any claims for damages.

Failure to follow the instructions may entail the following hazards, for example:

- Failure of important functions of the machine/system.
- Failure of prescribed methods for repair and maintenance
- Exposure of persons to electrical, mechanical, and chemical hazards.
- Environmental risks caused by leakage of hazardous substances.

2.4.2 Safety-conscious work behaviour

Follow the safety instructions contained in this operating manual, the relevant national accident prevention regulations as well as any internal working, operating, and safety provisions of the operating company.

2.5 Unauthorised modification and ordering of spare parts

Modification or alteration of the machine is only permitted with the written permission of the manufacturer.

Exclusive use of original spare parts and accessories authorised by the manufacturer ensures safety. The manufacturer will bear no liability for consequences arising from the use of unauthorised parts.

2.6 Staff qualifications and training

The staff for working on and with the pump must have the appropriate qualifications. Responsibilities, competencies and supervision of staff must be clearly defined by the operating company. If personnel do not have the necessary knowledge, they are to be trained and instructed. If necessary, this can be done by the product manufacturer/vendor on behalf of the operating company. The operating company must also ensure that the contents of the operating instructions are fully understood by the staff.

2.7 Safety equipment

Do not remove instructions from the pump.

Signs attached directly on the machine, such as an arrow to indicate the direction of rotation, must absolutely be observed and kept in fully legible condition.

Damaged or illegible signs must be replaced.

2.8 Possible residual hazards



Hint!

Despite careful design of the machine and the implementation of all safety-relevant regulations, further risks for persons and machine during all life phases of the pump cannot be fully ruled out. The additional safety instructions in the individual chapters of this manual must therefore be carefully observed!

The residual risks that were ascertained during the risk assessment carried out for the product according to safety standard EN ISO 14121 - Safety of Machines - are:

- mechanical hazards due to sharp sheet metal edges and projecting parts
- electrical hazards as a result of inadvertently coming in contact with terminals and cables
- thermal hazards as a result of inadvertently coming in contact with pump housings and pipes
- exposure to noise
- hazards caused by vibration due to improper installation
- hazards due to working materials and other materials in case of allergies or the like.
- neglect of ergonomic principles
- combinations of various hazards
- unexpected starting, unexpected rotation in case of wrong electrical connections or defects
- shut down, emergency stop when defects are detected
- changes to the rotational speed
- power failure
- Hazard from insufficient / incorrect cleaning - Product contamination,

- failure of the control circuit or control loop
- incorrect assembly
- fracture during operation
- operating media or objects getting thrown out
- loss of stability
- personnel slipping, tripping or falling

3 Description

3.1 Pump overview

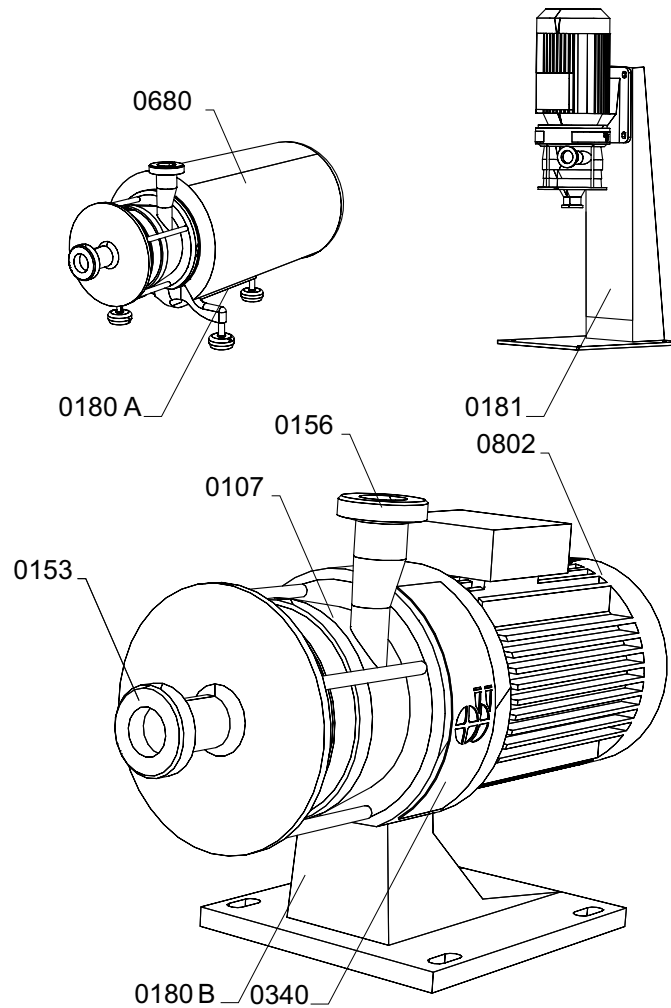

Fig.1: Pump overview

0107 - Discharge casing
0153 - Suction port
0156 - Discharge port
0180 A - Foot (combi foot)
0180 B - Foot (cast iron foot)

0181 - Pump stand (vertical stand)
0340 - BLOC motor stool
0680 - Shroud
0802 - Motor

3.2 Description

The pump is a normal-priming, single or multi-stage centrifugal pump in a system block design. All wetted parts are based on the “hygienic design” guidelines. The material grade 1.4404 or 1.4435 Fe ≤ 1% and the respective execution standard are carried out according to the order and, if required, certified in writing.

3.2.1 Standard version applications

The standard version of the pumps is used in the following areas:

- Breweries (beer, wort, mash, yeast, etc.)
- Dairies (milk, milk mixes, cheese production, etc.)
- Soft drinks (fruit juice, lemonade, mineral water, etc.)
- Wine and sparkling wine production
- Distilleries (mash, distillates, etc.)
- Food production (marinades, pickle, cooking oil, etc.)
- Cleaning systems (CIP)

3.2.2 Hygienic design applications

Due to the consistent hygienic design and the use of pore and porosity-free materials, the pump is ideally suited for use in the following areas:

- pharmaceutical industry
- medical technology
- in biotechnology process plants

Special applications arise in the area of ultrapure water delivery/WFI, as well as in equipment for the production of parenterals and infusion solutions according to FDA.

3.3 Pump name

GEA Hilge pump name					
GEA Hilge CONTRA	I/3	BLOC	40/40	3	2
Pump name	Size / number of stages	Design type	Nominal width	Output [kW]	Number of poles

3.4 Name plate

The following information is given on the name plate:

- Pump-Type: Pump name
- Ser.-No.: Serial number
- Q: Flow rate
- H: Delivery head
- P: Motor rating
- n: Speed

Description

- TAG No.:customer name
- YOM: Year of manufacture

4 Transport and Storage

4.1 Special personnel qualification for transport and storage

Transports may only be carried out by qualified staff, who must observe the safety instructions.

4.2 Safety precautions for transport and storage

4.3 Safety instructions for transporting the pump

Warning!

Falling loads

Observe the following instructions when transporting the pump:

- ▶ To transport the pump, use suitable lifting gear with sufficient carrying capacity.
- ▶ Make sure that there are no persons present under suspended loads.
- ▶ Make sure that the pump is horizontally aligned when lifting.
- ▶ Attach the rope to suitable anchor points.
- ▶ Never fasten a rope to the pump housing or the suction/discharge port!
- ▶ For version with casing: Remove the stainless steel casing before transport.

4.4 Attachment points for lifting loads

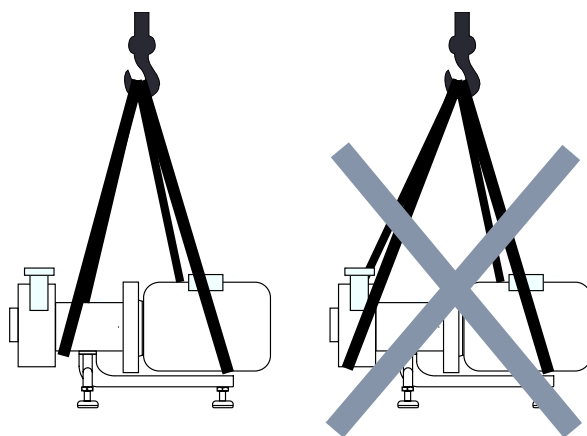

Fig.2: Attachment points

4.5 Storage of the pump

Follow the following instructions for the storage of the pump:

- The maximum storage period is two years.
- In case of frost risk, drain the pump completely. Protect the pump from low temperatures.
- If the pump is not used immediately, proper storage conditions are as important for later operation as careful installation and proper maintenance.
- During storage, the pump should be turned by hand at least once a month. Parts such as shaft and bearings should change their position.

- After a longer storage period (more than 6 months), all elastomers (O-rings, shaft seals) must be checked for their elasticity. Brittle elastomers must be replaced.
- Protect the pump from cold, moisture and dust, as well as from mechanical influences.
- Qualified personnel is required for proper installation and maintenance.

4.6 Dimensions / weights

The weights may differ from the ones shown here depending on the version and accessories. Please contact the manufacturer for accurate information and quote the pump / order number.

(Installation: combi foot, mechanical seal)

Weight [kg] CONTRA I BLOC			
Stages	Motor output [kW]	Motor size	Bloc Weight [kg]
1	0.75	80	24.5
1	1.1	80	25.5
1	1.5	90S	24.7
2	1.5	90S	26
2	2.2	90L	33.8
2	3.0	100L	38.6
3	1.5	90S	27.3
3	2.2	100L	35.1
3	3.0	100L	39.9
3	4.0	112M	43.9
4	2.2	100L	36.4
4	3.0	100L	41.2
4	4.0	112M	45.2
4	5.5	112M	50.2
5	3.0	100L	42.5
5	4.0	112M	46.5
5	5.5	112M	51.5
6	3.0	100L	43.8
6	4.0	112M	47.8
6	5.5	112M	52.8
Weight [kg] CONTRA II BLOC			
Stages	Motor output [kW]	Motor size	Bloc Weight [kg]
2	4	112M	67.3
2	5.5	112M	71
2	7.5	132S	76.3
2	11	132M	111.9
3	5.5	132S	73.8

Weight [kg] CONTRA II BLOC			
Stages	Motor output [kW]	Motor size	Bloc Weight [kg]
3	7.5	132S	78.8
3	11	132M	115
3	15	160L	125.9
4	7.5	132S	81.3
4	11	132M	116.7
4	15	160L	128.4
4	18.5	160L	143.4
5	11	132M	119.8
5	15	160L	130.9
5	18.5	160L	145.9

4.7 Unpacking the pump

All of our pumps leave our warehouse properly packaged to avoid damage in transit.

Should you nevertheless find any damage after cautious unpacking and exact inspection of the shipment, immediately notify the carrier (railway, post, freight forwarder, shipping company). Make claims for damages. The transport risk passes to the customer once the shipment has left our warehouse.

4.8 Disposal of packaging material

The generation of waste should be avoided or minimized wherever possible. Surpluses and packaging materials not suitable for recycling should be disposed of through an approved waste disposal company. Packaging materials not suitable for recycling must always be disposed of in accordance with the requirements of environmental protection and waste disposal legislation as well as the requirements of the local authorities.

Packaging materials suitable for recycling should be reused or reprocessed.

5 Technical data

The operating safety of the delivered machine is only guaranteed if the machine is used as intended according to the sections of the operating instructions and the purchase order.

Warning!

Overload of the pump!

- ▶ Do not operate the pump above the maximum permissible operating data.
- ▶ Avoid even short-term pressure overloads (e.g. by pressure surges).

5.1 Serial number

The pump can be uniquely identified by the serial number. When ordering spare parts, always quote the serial number. The serial number is indicated on the nameplate.

5.2 Performance data

The performance data - delivery head and flow rate - are explained in accordance with ISO 9906: 2012, Grade 3B and documented with the acceptance report.

5.3 Noise emissions

Measured values in accordance with DIN EN ISO 3746 for pump units, measuring uncertainty 3 DB(A).

The noise emissions caused by a pump are influenced mainly by its application. The values shown here should therefore be considered merely as a guide.

Noise emissions L_{pfa} [dB (A)] - CONTRA I, 2-pole						
Motor rating [kW]	1-stage	2-stage	3-stage	4-stage	5-stage	6-stage
0.75	61	-	-	-	-	-
1.1	61	-	-	-	-	-
1.5	63	64	65	-	-	-
2.2	-	64	64	66	-	-
3.0	-	69	70	71	73	74
4.0	-	-	68	70	72	72
5.5	-	-	-	70	72	73

Noise emissions L_{pfa} [dB (A)] - CONTRA II, 2-pole				
Motor rating [kW]	2-stage	3-stage	4-stage	5-stage
4	66	-	-	-
5.5	69	71	-	-
7.5	69	70	72	-
11	73	75	75	77
15.0	-	73	75	76
18.5	-	-	74	77

5.4 Maximum operating temperatures

Warning!

Exceeding the maximum temperatures!

- ▶ Never exceed the specified operating temperatures.

Operating temperatures	
Design	Temp. [°C]
Normal version	95
Sterilisation (SIP)	140

Other temperatures on request.

5.5 Maximum operating pressure

Warning!

Pressure overload of the pump!

- ▶ Operate the pump according to the ordering data.
- ▶ Never exceed the specified maximum operating pressures.

The pump's maximum operating pressure pump depends on various factors:

- Pump type
- Type of connections
- Type of mechanical seal.

5.6 Resistance of Sealing Materials

The resistance of sealing materials depends on the type and temperature of the medium conveyed. The exposure time can adversely affect the service life of the seals. The sealing materials comply with the regulations of FDA 21 CFR 177.2600 or FDA 21 CFR 177.1550.

Resistance:

- + = good resistance
- o = reduced resistance
- - = no resistance

Sealing resistance table			
Medium	Temperature	Gasket material (general operating temperature)	
		EPDM -40...+135°C (-40...275°F)	FKM -10...+200 °C (+14...+392°F)
Caustics up to 3%	up to 80 °C (176°F)	+	o
Caustics up to 5%	up to 40 °C (104°F)	+	o
Caustics up to 5%	up to 80 °C (176°F)	+	-
Caustics at more than 5%		o	-
Inorganic acids up to 3%	up to 80 °C (176°F)	+	+

Technical data

Sealing resistance table			
Medium	Temperature	Gasket material (general operating temperature)	
		EPDM -40...+135°C (-40...275°F)	FKM -10...+200 °C (+14...+392°F)
Inorganic acids up to 5%	up to 80 °C (176°F)	o	+
Inorganic acids up to 5%	up to 100 °C (212°F)	-	+
Water	up to 80 °C (176°F)	+	+
Steam	up to 135 °C (275°F)	+	o
Steam, approx. 30 min	up to 150 °C (302°F)	+	o
Fuels/hydrocarbons		-	+
Product with a fat content of max. 35%		+	+
Product with a fat content of more than 35%		-	+
Oils		-	+

* Depending on the installation conditions

6 Assembly and installation

6.1 Safety precautions for setup, installation, and connection

Warning!

Tipping (tilting) of the pump!

- ▶ The surface for setting up the pump should be clean, level and have sufficient load-bearing capacity.
- ▶ Bolt the provided fastening points to the foundation for proper setup of the pump according to the usual rules of mechanical engineering.

Warning!

Mechanical overload!

- ▶ Do not use the pump and its connection port as support of the piping. (EN 809 5.2.1.2.3 and EN ISO 14847).
- ▶ Follow the general rules of mechanical engineering and plant construction and the regulations of the manufacturers of connecting elements (e.g. flanges). These regulations may include information on tightening torques, max. permissible angular misalignment, tools/equipment to use.
- ▶ Be sure to avoid any strain on the pump.
- ▶ After piping, check the alignment of the coupling (where applicable).

Caution!

Overload by foreign bodies!

- ▶ Before installing the pump in the system, remove all plastic films and caps from the connectors.

Caution!

Dry running of the mechanical seal!

- ▶ The suction line must be hermetically sealed and laid such that no air pockets can form.
- ▶ Avoid tight bends and valves directly in front of the pump. They impair the incoming flow of the pump and the NPSH of the system.
- ▶ The suction head of the system must not be larger than the suction head guaranteed by the pump.
- ▶ The piping nominal diameters of the system should be equal to or greater than the DNE or DNA connections of the pump.
- ▶ For suction operation, install a foot valve.
- ▶ Route the suction line in ascending direction and the supply line at a slight slope towards the pump.
- ▶ If the local conditions do not permit a continuous ascent of the suction line: Provide a vent at its highest point.
- ▶ Install a shut-off valve in the supply line close to the pump.
- ▶ Open the suction side shut-off valve completely during operation.
- ▶ Do not use the suction side shut-off valve for controlling.
- ▶ Install a shut-off valve in the pressure line close to the pump. This can be used to control the flow rate.

Warning!

Overheating!

- ▶ Ensure adequate ventilation.
 - ▶ Avoid sucking in the heated exhaust air also of adjacent units.
 - ▶ Maintain minimum distances.
-

Caution!

Vibration!

- ▶ Ensure stable construction for mounting of the pump and piping. Insufficiently stiffened substructures may cause an overall structure capable of oscillating, which is excited to oscillate by hydraulic and/or motor forces during changing operating conditions in the system.
-

Danger

Electric shock by touching live parts!

- ▶ Have the electrical connections be made by a licensed electrician.
 - ▶ Follow the VDE as well as local regulations, in particular the safety regulations.
-

Danger

For motors with frequency converter (tronic): Electric shock by touching live parts!

- ▶ Even if the power supply is switched off, touching electrical parts may cause an electric shock.
 - ▶ Disconnect the power supply and wait at least four minutes before touching electrical components.
-

Warning!

Electric overload!

- ▶ Compare the voltage indicated on the motor plate with the operating voltage. The power supply properties must match the specifications on the type plate.
 - ▶ Install a motor protection switch.
-

Caution!

Voltage spikes in frequency converter operation!

- ▶ Use a motor suitable for frequency converter operation.
 - ▶ Use a dU/dt filter to avoid voltage spikes or a motor with reinforced windings.
-

6.1.1 Mechanical seals in tandem arrangement and Quench

 **Caution!**

Missing supply of flushing fluid!

Dry running of the mechanical seal.

- ▶ Always connect the flushing lines such that supply for flushing is always ensured.
 - ▶ Ensure that flushing fluid is supplied even when checking the motor's direction of rotation.
 - ▶ Ensure that the flushing pressure does not exceed 0.2 bar / 2.9 psi.
 - ▶ Always keep the level in the liquid tank between the upper and the lower mark (where applicable).
-

6.1.2 Mechanical seals in back-to-back arrangement

 **Caution!**

Missing sealing water supply!

Dry running of the mechanical seal.

- ▶ Always connect the flushing lines such that supply for flushing is always ensured.
 - ▶ Ensure that flushing fluid is supplied even when checking the motor's direction of rotation.
 - ▶ For back-to-back arrangement, ensure that the sealing pressure is at least 1.5-2.0 bar (22-29 psi) above the maximum internal pressure of the pump. Max. internal pressure = system pressure + pumping pressure at Q = zero.
 - ▶ Always keep the level in the liquid tank between the upper and the lower mark (where applicable).
-

6.1.3 Vertically installed pumps

 **Warning!**

Tipping (tilting) of the pump

- ▶ Fasten the pump with suitable heavy-duty anchors. The pump tends to tip over due to the elevated centre of gravity.
-

 **Warning!**

Short-circuit

- ▶ Position the pump part always below the motor. If leakage occurs, the liquid cannot ingress into the motor.
-

6.2 Special personnel qualification

The personnel used for setup, installation and connection must be adequately qualified for this work. See also Section 2.6, Page 14.

6.3 Setup, installation, and connection

6.3.1 Checking smooth running of the impeller

Before installation, check that the impeller is running smoothly.

Perform the following steps:

1. Remove the motor shroud (only for SUPER version).
2. Remove the motor fan cover.
3. Note the pump's direction of rotation (arrow).
4. Carefully rotate the shaft of the impeller.

The shaft should be easy to rotate. If the impeller rubs against something, it has some damage that may have happened during transport of the pump.

In case of rubbing of the impeller: Contact the GEA Hilge service.

If the impeller rotates freely:

5. Reattach the motor fan cover.
 6. Reattach the motor shroud (only for SUPER version).
- The impeller has been checked for running smoothly.

6.3.2 Setting up and aligning the pump unit

The pump is designed for horizontal and vertical operation.

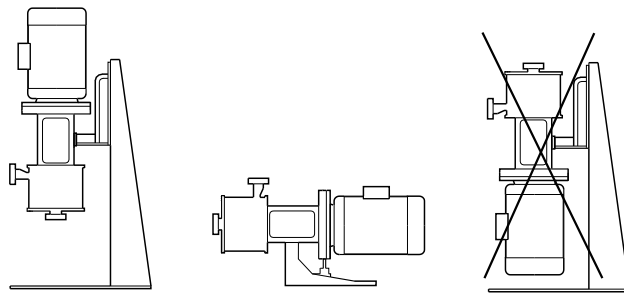

Fig.3: Permissible setups of the pump

Aligning the pump:

1. Level the unit via the machined planar surfaces of the ports using a machine spirit level.
 2. After aligning the unit, tighten the fastening screws evenly in a crosswise sequence (where applicable).
- The pump unit has been set up and aligned.

6.3.3 Installation in the piping system

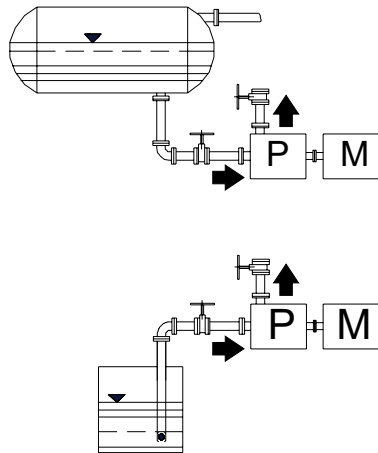

Fig.4: Installation in the piping system
top: Inlet operation | bottom: Priming operation (only self-priming pumps) | P - Pump | M - Motor

6.3.3.1 Space requirements

Maintain the following minimum distances.

Pay attention to motor performance.

Horizontal installation

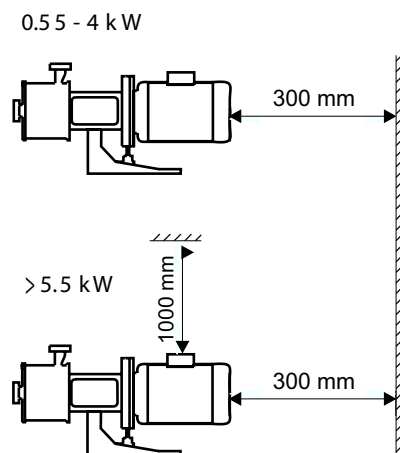

Fig.5: Minimum distances in horizontal installation

Vertical assembly

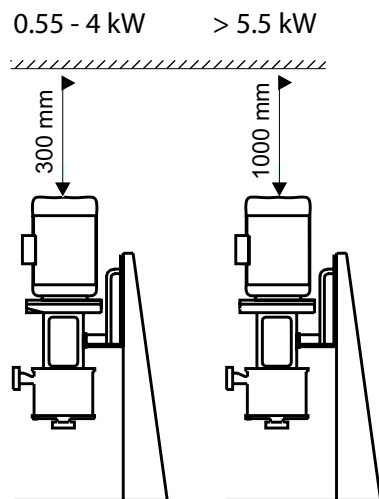

Fig.6: Minimum distances in vertical assembly

6.3.3.2 Noise and vibration damping

To achieve optimum performance and to minimize noise and vibration, it is recommended to provide the pump with vibration dampers.

In general, this should always be considered for pumps with motor sizes starting from 11 kW (15 HP). But unwanted vibrations and noises occur also with smaller motor sizes.

Noise and vibration are caused by the rotating parts in the motor and the pump and by the flow in the pipes and fittings.

The effect on the environment is subjective and depends largely on the correct installation and the nature of the rest of the system.

Foundation

Vibration damping is best achieved if the pump is set up on a flat, solid concrete foundation.

As a guideline, the concrete foundation should be 1.5 times as heavy as the pump.

Vibration damper

To avoid the transmission of vibrations to the building, it is recommended to disconnect the pump foundation from parts of the building using vibration dampers.

Selecting the correct vibration damper requires the following data:

- Forces transmitted via the vibration damper
- Motor speed, if necessary, taking into account a speed control
- Required damping in % (suggested value: 70 %)

The correct damper depends on the respective installation. An incorrectly designed damper may even increase the vibration. Vibration dampers should therefore be designed by the vendor of the vibration damper.

Compensators

If the pump is mounted on a foundation along with vibration dampers, be sure to install compensators at the pipe connections. This prevents the pump from “hanging” in the connections.

Compensators are installed to

- absorb expansion/shrinking in the piping caused by varying fluid temperatures;
- reduce mechanical stress occurring in conjunction with pressure surges in the system;
- absorb noise caused by the system in the piping (only rubber ball compensators).

Note: Compensators must not be used to compensate for inaccuracies in the piping, for example, to compensate for an offset in the centre of the connections.

Install the compensators both on the suction side and pressure side at a minimum distance to the pump, which is 1-1.5 times the nominal diameter of the piping. This allows for an improved flow on the suction side of the pump, as well as reduced pressure drop on the pressure side.

For connections larger than DN 100 (4"), we always recommend compensators with length limiters.

The pipes must be started so that they can cause no strain in the compensators and in the pump. Follow the manufacturer's instructions and hand them over to the person responsible or to the plant manufacturer.

Vibration may cause the following damage:

- Damage to roller bearings of pump and motor
- Damage to the mechanical seal
- Increased coupling wear
- Damage to shaft/hub connections
- Cracks on pump ports
- Loosening of screw connections
- Cable breaks in the motor connection
- Contacting of pump impellers.

Acoustic decoupling

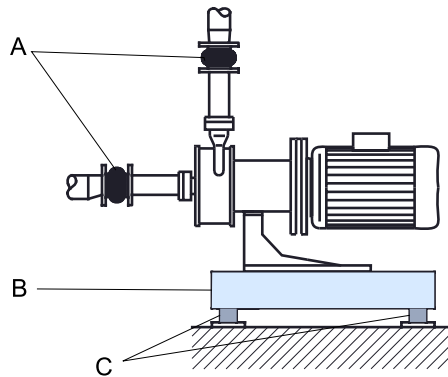

Fig.7: Example of a foundation of a pump
A - compensators | B - solid base | C - Vibration damper

6.3.4 Using the mechanical seal

For perfect operation, mechanical seals require a lubrication film in the sealing gap, which prevents contact between the two sliding surfaces. Usually this lubrication film is formed by the pumped product or by an externally supplied flushing/sealing fluid.

Due to the friction heat between the sliding faces, the lubrication film evaporates towards the atmosphere. This means there is a leak that is invisible in water, water-like or volatile liquids (e.g. alcohol). The amount of leakage for faultless operation is usually only a few ml/h; however, it may multiply depending on other influences.

Particularly in the running-in phase, mechanical seals, regardless of size, type or design, are subject to low leakage. In individual cases, it may be necessary to tolerate a low, visible leakage or to counteract it with suitable measures.

Dry run

The mechanical seal needs a lubrication film between the sliding surfaces for correct sealing.

If the lubrication film is missing or interrupted between the sliding surfaces, dry running occurs. The friction heat generated by the direct contact of the sliding surfaces leads to the destruction of the mechanical seal. Depending on the material pairing, this can take place within a few seconds.

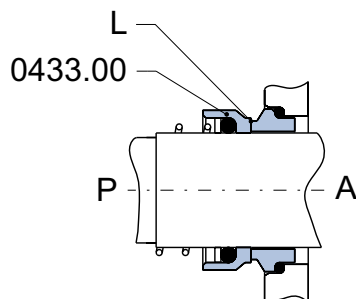

Fig.8: Lubrication film between the sliding surfaces
P - Pump side | A - Atmosphere side | L - Lubrication side | 0433.00 - Mechanical seal

6.3.5 Flush connections for double mechanical seals (optional)

6.3.5.1 Flushing fluid (optional)

Requirements of the flushing fluid

The flushing fluid has the task to lubricate and cool the product-side mechanical seal and the radial packing ring on the atmospheric side.

The flushing fluid must meet the following criteria:

- good flowability
- no impurities
- no solids
- no dissolved components
- adequate thermal conductivity
- no chemical or mechanical attacking of the pump materials, sealing materials, and elastomers.
- No contaminating of the pumped fluid
- Viscosity < 5 mPas
- Water hardness < 5° dH

Demineralised water meets these requirements to a large extent.

6.3.5.2 Double mechanical seals (optional)

Pumps with double-acting mechanical seals are equipped with a seal cartridge. This seal cartridge holds the sealing or flushing fluid, depending on the seal version. The connections for flushing must be made as shown. Only in this way can the flushing fluid flow effectively around the mechanical seal.

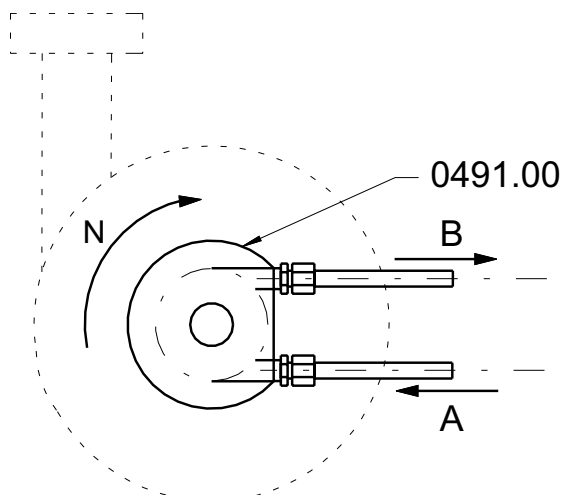

Fig.9: Flush ports

A	Inlet line
B	Outlet line
N	Direction of rotation of the pump
0491.00	Seal housing

Connecting the flushing

1. Connect the inlet line (A).

Note position of the lines depending on the direction of rotation.

2. Connect the outlet line (B).
3. Check correct fit of the connections.
→ The flushing has been connected.

Double mechanical seal - back-to-back arrangement (optional)

Sealing fluid

To maintain their function, mechanical seals need a sealing fluid, which has the following tasks, including others:

- Pressure build-up in the sealing space
- Preventing penetration of fluid into the sealing gap
- Protection against dry running
- Lubrication and cooling of the mechanical seals.

A clean liquid, compatible with the pumped fluid, is used as the sealing fluid.

Ensuring the flushing operation:

1. Open the inlet of sealing fluid.
2. Vent the seal cartridge.
3. Ensure circulation at necessary sealing pressure.
→ Done.

Permissible supply pressures and temperatures

The supply of the mechanical seal with sealing fluid must be pressurised. The sealing pressure should be at least 1.5-2.0 bar (22-29 psi) above the maximum internal pressure of the pump. Max. internal pressure = system pressure + pumping pressure at Q = zero. Obtain the delivery head at Q=0 from the test bench acceptance of your pump.

When operating with a frequency converter, consider the varying delivery heads. When using a closed sealing circuit with a supply reservoir, regularly monitor the fill level (visually or by means of level probes). Change the sealing fluid regularly when using critical media.

The maximum temperature of the flushing fluid must be 20 K below the boiling temperature of the flushing fluid at the outlet. The temperature rise in the pump flushing chamber is normally less than 10 K (inlet/outlet). The maximum permissible operating temperatures of the flushing device must not be exceeded.

Double mechanical seal - tandem arrangement (optional)

Flushing fluid

To maintain their function, mechanical seals need a flushing fluid, which has the following tasks, including others:

- Dissipation of any leakage

- Protection against dry running
- Lubrication and cooling of the mechanical seals

A clean liquid, compatible with the pumped fluid, is used as the flushing medium.

Ensuring the flushing operation

1. Open the inlet of flushing fluid.
2. Vent the seal cartridge.
3. Ensure pressureless circulation.
→ Done.

For abrasive media, use lost flushing in which the flushing fluid is discharged directly.

Permissible supply pressures and temperatures

The supply of the mechanical seal with flushing fluid must be unpressurised. The maximum overpressure may not exceed 0.2 bar (2.9 psi). When using a pass-through flushing, secure the flushing fluid connection with a pressure reducer or similar if necessary.

When using a closed flushing circuit with a supply reservoir, regularly monitor the fill level (visually or by means of level probes). Also, make sure that no pressure build-up can occur in the flushing circuit. Keep the reservoir open to the atmosphere. Change the flushing fluid regularly when using critical media.

The maximum temperature of the flushing fluid must be 20 K below the boiling temperature of the flushing fluid at the outlet. The temperature rise in the pump flushing chamber is normally less than 10 K (inlet/outlet). The maximum permissible operating temperatures of the flushing device must not be exceeded.

Leakage outflow for mechanical seal when installed vertically

Vertically installed pumps from the CONTRA range must be fitted with a discharge for any mechanical seal leakages.

If pumped medium escapes through this discharge:

1. Check function of mechanical seal.
 2. Replace mechanical seal, if required.
 3. Connect pipeline (G $\frac{1}{4}$ " thread).
- Controlled discharge of the leak.

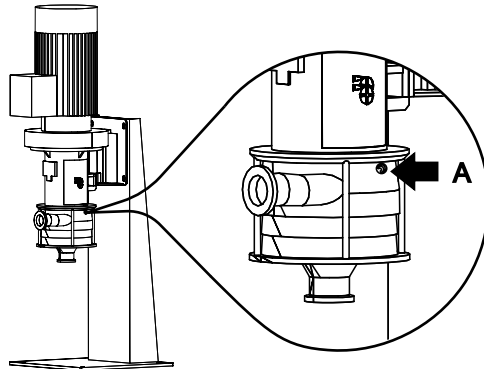

Fig.10: Leakage outflow (A)

6.3.6 Electrical connection



Danger

Electric shock by touching live parts!

- ▶ Have the electrical connections be made by a licensed electrician.
- ▶ Observe local laws, standards and regulations - especially safety precautions.

6.3.6.1 Star connection

Star connection for high voltage.

Connect the pump according to the ordering information. The following figure shows the wiring diagram of the star connection.

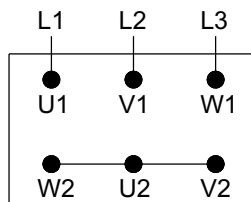

Fig.11: Star connection

6.3.6.2 Delta connection

Delta connection for low voltage.

Connect the pump according to the ordering information. The following figure shows the wiring diagram of the delta connection.

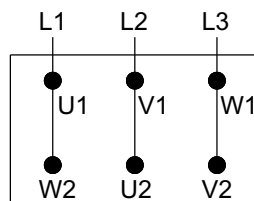

Fig.12: Delta connection

6.3.6.3 Frequency converter operation

All three-phase motors can be connected to a frequency converter. Frequency converter operation may subject the insulation of the motor to a higher load so that louder motor noise than in the normal case may occur due to eddy currents caused by voltage spikes.

Large motors driven by a frequency converter are loaded by bearing currents. For pump motors that are used with an external frequency converter, HILGE recommends the use of insulated motor bearings for sizes of 22 kW and above to avoid increased wear of the motor bearings by possible bearing currents.

Check the following operating conditions if the pump is operated using a frequency converter:

Operation with frequency converter	
Operating Conditions	Measures
Noise-sensitive applications	Install a dU/dt filter between the motor and frequency converter (reduces voltage spikes and thus noise).
Particularly noise-sensitive application	Install sinusoidal filter.
Cable length	Use a cable which satisfies the conditions prescribed by the manufacturer of the frequency converter.
Supply voltage up to 500 V	Check that the motor is suitable for frequency converter operation.
Supply voltage between 500 V and 690 V	Install a dU/dt filter between the motor and the frequency converter (reduces voltage peaks and thus noise), or check whether the motor has a reinforced insulation.
Supply voltage 690 V and above	Install a dU/dt filter between the motor and the frequency converter and check whether the motor has a reinforced insulation.

Notice

Incorrect operation of the frequency converter!

► Follow the manufacturer's instructions to install and operate a frequency converter.

6.3.6.4 Checking the direction of rotation after connecting

Perform the following steps:

1. Re-install all safety devices.
2. With double mechanical seal in back-to-back arrangement, connect the sealing fluid (see Section 6.3.5, Page 33).
3. Check that hydraulic connections are firmly secured.
4. Open stop valves.
5. With double mechanical seal in tandem arrangement, connect the flushing fluid (see Section 6.3.5, Page 33)
6. Fill the pump (system).
7. Note the direction-of-rotation arrow on the pump.
8. Switch on the motor briefly (1-2 seconds).

9. Compare the direction of rotation with the specified direction (arrow).
10. Correct the connection if necessary.
 - The direction of rotation has been checked, and corrected if necessary.

6.3.6.5 Earthing



Warning!

Electrical voltage by different potentials.

The occurrence of potential differences can cause damage to persons and property.

- ▶ Properly earth the pump and motor to achieve potential equalisation.
-

Earthing the motor

Equipotential bonding for the motor is performed via the protective conductor connection in the terminal box.

Earthing the motor shroud

Equipotential bonding of the motor shroud is achieved using a suitable earthing cable. For this purpose, connect the earth cable at the intended location on the motor stool.

7 Commissioning

7.1 Special personnel qualification

The commissioning personnel must be suitably qualified for this work. See also Section 2.6, Page 14.

7.2 Safety instructions for commissioning

 **Caution!**

Hazard due to overheating and pressure overload!

- ▶ Never pump for longer than 30 seconds against a closed shut-off device. Pumping against a closed shut-off device leads to rapid warming of the pumped fluid and pressure increase.
 - ▶ Do not exceed the permissible operating temperatures.
-

7.3 Commissioning / initial startup

7.3.1 Checking conditions of use

Compare the information in the following documents with the intended conditions of use of the pump:

- Order documents (order confirmation)
- Nameplate
- Operating instructions
- Test bench acceptance
- Make sure that the pump is operated only under the specified conditions of use. These conditions apply to pressure, temperature, fluid, etc.

7.3.2 Vent pump

Notice

Dry running of the mechanical seal

Pumps that have not been fully vented will destroy the mechanical seal.

- ▶ Vent pump correctly as described and place in operation.
-

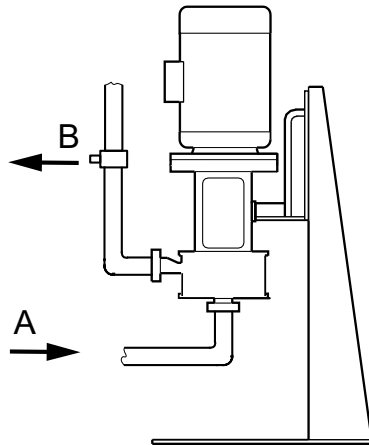

Fig.13: Vertically installed pump
A - Suction pipeline | B - Discharge valve in the pressure pipeline

Perform the following steps:

1. Open discharge valve (B) in the pressure pipeline.
2. Fill pump and system via the suction pipeline (A).
The air will now be expelled from the pump.
If only the product to be pumped (e.g. water) is flowing out of the discharge valve:
3. Close the discharge valve (B)
→ The pump is vented.

7.3.3 Commissioning of the pump

⚠ Caution!

Hazard due to overheating and pressure overload!

- ▶ Never pump for longer than 30 seconds against a closed shut-off device. Pumping against a closed shut-off device leads to rapid warming of the pumped fluid and pressure increase.
 - ▶ Do not exceed the permissible operating temperatures.
-

Perform the following steps:

1. Check that all connections are firmly secured.
2. Make sure that all safety devices are installed.
3. Make sure that the electrical connections are correct.

-
4. Ensure that the pipe system provided by the customer is cleaned.
 5. For double mechanical seal in back-to-back arrangement, connect the sealing fluid. Start flushing to prevent dry running.
 6. Open stop valves in the system.
 7. Fill the pump along with the system.
 8. Vent the pump along with the system.
 9. For double mechanical seal in tandem arrangement, connect the flushing fluid. Start flushing to prevent dry running.
 10. Fully open the suction-side stop valve.
 11. Close the pressure side stop valve.
 12. Switch on the pump.
 13. Slowly open the pressure side stop valve.
→ This completes the commissioning.

If there is no increase of delivery head after commissioning:

1. Switch off the pump.
2. Again vent the pump (system).
3. Repeat steps 7 to 10, and follow Section 10.3, Page 49.

7.3.4 Functional testing of the mechanical seal

Perform the following steps:

1. Inspect the pump and check whether liquid exits at the mechanical seal.
An intact mechanical seal operates virtually without any leakage.

If pumped fluid or flushing fluid exits:

1. Switch off the pump.
2. Replace the mechanical seal.
Follow chapter *Assembly instructions*.

8 Cleaning

To ensure the quality of sensitive fluids, pumps must be cleaned immediately after each use. Only in this way will adhesions and deposits be removed completely and contamination of the products be prevented. To achieve the best possible results, Hilge pumps are optimised with regard to gap and dead spaces, designed according to DIN EN 13951, and resistant to the cleaning agents referred to in the following chapter. Cleaning is carried out inside the system; no parts need to be removed or dismantled.

In general, a distinction is made between CIP and SIP. The procedures must comply with the state of the art and the EC directives. In any case, the operator must ensure that the target specifications are reached and applied as intended using the cleaning and sterilisation procedures, as well as the working temperatures and steps.

8.1 Special personnel qualification

The cleaning personnel must be suitably qualified for this work. See also Section 2.6, Page 14.

8.2 Safety instructions

Warning!

Damage caused by cleaning agents!

- ▶ Use only suitable cleaning agents.
- ▶ Observe the safety instructions in the product descriptions of the cleaning agents.
- ▶ Use always suitable personal protective equipment when handling cleaning agents.
- ▶ Be sure to avoid exceeding the permissible concentrations of cleaning agents.
- ▶ Reducing acids should not be used, because they cause pitting.

Warning!

Risk of burns!

- ▶ Do not touch the pump during cleaning. The surfaces may be very hot.

Warning!

Danger of scalding or burns.

- ▶ Do not touch the pump during steam sterilisation and the cooling phase. Surface temperatures may rise above 100 °C (212 °F).

Caution!

Dry running of the mechanical seal!

- ▶ Do not run the pump during steam sterilisation. Destruction of the mechanical seal!

Warning!

Pressure shock by evaporating liquid!

- ▶ Completely empty the system before steam sterilisation.

Notice

Disposal of cleaning agents

- ▶ Dispose of cleaning agents properly and in an environmentally friendly way.

8.3 CIP

CIP stands for Cleaning in Place, the pump is completely rinsed with cleaning agents. The cleaning agent used must be suitable for the respective cleaning task.

The following table lists approved detergents and disinfectants and their permitted concentrations. Alternatively, information from DIN11483 Part 1 can be used.

Cleaning and disinfecting agents						
Cleaner type	Chemical name	Max. concentration	Max. temperature	Permissible pH	Max. permissible CI content in the preparation water	Max. permissible contact time
		[%]	[°C] (°F)		[mg/l]	[h]
Alkaline	NaOH	2.5%	85 (185) ¹	13-14	150	3
Acid	H ₂ SO ₄ H ₃ PO ₄ HNO ₃	2% ^{2,3}	60 (140)		150 ^{2,3}	1
	C ₂ H ₄ O ₃	0.0075%	90 (194)		150	0.5
	C ₂ H ₄ O ₃	0.15%	20 (68)		150	2
	Iodophore	50 mg/l act. Iodine	30 (86)	>3	150	3

Cleaning agents that contain hydrochloric acid (HCl) or hydrofluoric acid (HF) must not be used. Consult the supplier for the use of special cleaning agents and procedures with respect to the materials. Thoroughly rinse the pump with water to remove any cleaning agents leaving no residues. The maximum permissible temperatures can be obtained from the technical data.

1 Dependent on the maximum permissible temperature of the pump
 2 CrNi-steels
 3 CrNiMo-steels

8.4 SIP

SIP stands for sterilisation in place, in which the pump is sterilised with superheated steam. For steam sterilization or sanitization, minimum temperatures of 121 ° C (250 ° F) must be applied to all wetted surfaces. The maximum permissible temperatures can be obtained from the section technical data.

The pump must not be in operation during steam sterilisation. A cool-down period of at least one hour is required after the SIP process.

8.5 Manual exterior cleaning

Notice

Danger due to cleaning agents.

- ▶ Follow the manufacturer's instructions when using cleaning agents.
 - ▶ Wear safety glasses and gloves.
 - ▶ Dispose of cleaning agent properly.
 - ▶ Do not use a high-pressure water jet to clean the pumps.
-

- Regular manual external cleaning of the pump unit facilitates proper operation.
- Always check the impermeability of the motor (terminal box, condensation water holes) before each cleaning.
- Clean the outside of the pump with a soft cloth or brush and use warm water if necessary.
- When using a cleaning agent, make sure that it does not attack the surface of the pump unit.
- Remove dust and debris that may clog the fan and cooling fins of the engine.
- Dry cleaning is preferable to wet cleaning.
- The cleaning intervals depend on the degree of contamination.

9 Maintenance / servicing

9.1 Safety instructions for maintenance and servicing

Warning!

Improper execution of work!

- ▶ Maintenance and inspection should be carried out by authorised and qualified personnel.

Warning!

Danger from tilting / toppling over of the pump!

- ▶ Before carrying out maintenance and repair work, secure pump against tilting / toppling over.

Warning!

Hot system and pump parts.

- ▶ Always allow the pump to cool before maintenance.

Warning!

Missing protection and safety devices.

- ▶ After completion of work: Reinstall all protective and safety devices and put into operation.

9.2 Special personnel qualification

The maintenance personnel must be suitably qualified for this work. See also Section 2.6, Page 14.

9.3 Pump maintenance

9.3.1 Inspections

The pump is maintenance-free for the most part.

In order to prevent possible malfunctions, GEA recommends that regular visual inspections be carried out. Special attention should be paid to the leak tightness and the correct functioning of the pump.

In order to ensure maximum operational safety of the pump wear parts, such as the mechanical seal and O-rings, should be checked after 2000 hours of operation and replaced if necessary.

In any case, all seals must be checked and, if necessary, replaced during disassembly of the pump.

9.3.1.1 Replacement of O-rings

Notice

Hygiene risk, food safety

Worn out and not fully functional components may lead to the contamination of the pump.

- ▶ Pay close attention to the condition of the O-rings during regular inspections.

The O-rings must be replaced if any one of these characteristics are visible:

- The O-ring is deformed at one or more locations.
- The O-ring has cracks.
- The surface of the O-ring is porous, brittle or discoloured.
- The O-ring has lost its elasticity.

9.3.2 Maintenance intervals

To ensure the highest operational reliability, all wearing parts should be replaced at longer intervals.

The actual maintenance intervals can only be determined by the user since they depend on the operating conditions, for instance:

- daily period of use,
- switching frequency,
- type and temperature of the product,
- type and temperature of the cleaning solution,
- ambient conditions.

Maintenance Intervals	
Applications	Maintenance intervals (guideline values)
Media at temperatures of 60 °C to 130 °C (140 °F to 266 °F)	approx. every 3 months
Media at temperatures of < 60 °C (< 140 °F)	approx. every 12 months

9.4 Maintenance of the motor

Motors without grease nipple

Motors without grease nipple are equipped with lifetime lubrication. The grease life then depends on the bearing life. Prerequisite is that the motor must be used according to the specifications in the catalogue.

Motors with grease nipple

On motors with grease nipple, the specifications for relubrication, type of grease, grease quantity, and other information as applicable are given on the lubrication or nameplate.

Fig.14: Lubrication information plate of MGE motor (example)

1	Bearing on drive side
2	Type of grease
3	Ambient temperature
4	Ambient temperature
5	Bearing, not drive side
6	Grease grade
7	Lubricating interval
8	Lubricating interval

Note: The nameplate may differ from the presented layout.

10 Malfunctions / repairs

10.1 Special personnel qualification

The troubleshooting / repair personnel must be suitably qualified for this work.
See also Section 2.6, Page 14.

10.2 Safety instructions

Warning!

Improper execution of work!

- ▶ Repair work should be carried out by authorised and qualified personnel.

Danger

Electric shock by touching live parts!

- ▶ Always disconnect the pump from power before troubleshooting.

Danger

For motors with frequency converter (tronic): Electric shock by touching live parts!

- ▶ Even if the power supply is switched off, touching electrical parts may cause an electric shock.
- ▶ Disconnect the power supply and wait at least four minutes before touching electrical components.

Danger

Liquids squirting out under high pressure!

- ▶ Always depressurise the pump before troubleshooting.

Warning!

Hot system and pump parts!

- ▶ Always allow the pump to cool before troubleshooting.

Warning!

Inadvertent switch-on of the pump!

- ▶ Be sure to secure the pump against accidental switch-on.

Warning!

Contact with dangerous substances (e.g. by inhalation).

- ▶ Decontaminate a pump that delivers harmful media.

Warning!

Missing protection and safety devices!

- ▶ After completion of work: Reinstall all protective and safety devices and put into operation.

⚠ Caution!

Unsuitable tools!

- ▶ Make sure that all the parts can be mounted without damage.
- ▶ Use GEA Hilge assembly tools.

10.3 Malfunctions and remedies

Actions for troubleshooting		
Malfunction	Cause	Remedy
Pump does not deliver or pump delivers with inadequate power.	<ol style="list-style-type: none"> 1. Incorrect electrical connection (2 phases). 2. Incorrect direction of rotation. 3. Air in suction line or pump. 4. Back pressure too high. 5. Suction head too high, NPSH system (supply) too low. 6. Lines clogged or foreign bodies in the impeller. 7. Air inclusion due to defective seal. 	<ol style="list-style-type: none"> 1. Check electrical connection, and correct if necessary. 2. Change phases of power supply (swap motor poles). 3. Vent and prime suction pipe or pump. 4. Reset operating point according to the data sheet. Check system for contamination. 5. Raise suction side liquid level, fully open the stop valve in the suction line. 6. Open pump and eliminate malfunctions. 7. Check and, if necessary, replace pipe seals, pump housing seals and shaft seals.
Motor protection switch turns off, motor is overloaded.	<ol style="list-style-type: none"> 1. Pump is blocked due to clogging. 2. Pump is blocked by contacting due to strain on the pump body via the piping. (Check for damage.) 3. Pump runs beyond its rated operating point. 4. The fluid density or viscosity of the liquid is higher than stated in the order. 5. Motor protection switch is not set properly 6. Motor runs on 2 phases. 	<ol style="list-style-type: none"> 1. Open pump and eliminate malfunctions. 2. Install pump without strain, support piping by fixed points. 3. Adjust operating point according to data sheet. 4. If a lower power than specified is sufficient, reduce the flow rate on the pressure side: otherwise use a more powerful motor. 5. Check the setting, replace the motor protection switch if necessary. 6. Check electrical connection, replace defective fuse.
Pump causes too much noise. Pump runs unevenly and vibrates.	<ol style="list-style-type: none"> 1. Suction head too high, NPSH system (supply) too low. 2. Air in suction line or pump.¹ 3. Back pressure is less than indicated. 4. Impeller is unbalanced. 5. Worn internal parts. 6. Pump is strained (start-up noise - check for damage.) 7. Bearings are damaged. 8. Bearings have too little, too much or inappropriate lubricant. 9. Motor fan defective. 10. Foreign material in the pump. 	<ol style="list-style-type: none"> 1. Raise suction side liquid level, fully open the stop valve in the suction line. 2. Vent and prime suction pipe or pump. 3. Adjust operating point according to data sheet. 4. Clean, check and balance the impeller. 5. Replace parts. 6. Install pump without strain, support piping by fixed points. 7. Replace bearings. 8. Add, reduce or replace lubricants. 9. Replace the fan motor. 10. Open and clean the pump (for self-priming pumps, install a screen if necessary).

Actions for troubleshooting		
Malfunction	Cause	Remedy
Leakage at the pump body, connections, mechanical seal, gland or socket seal.	1. Pump is strained (causing leaks at the pump body or at the connections).	1. Install pump without strain, support piping by fixed points.
	2. Housing seals and connection seals defective.	2. Replace housing seals and/or connection seals.
	3. Mechanical seal soiled or sticky.	3. Check and clean mechanical seal.
	4. Mechanical seal worn.	4. Replace the mechanical seal.
	5. Surface of shaft or shaft sleeve shrunk.	5. Replace shaft or shaft sleeve, repack gland seal.
	6. Elastomer unsuitable for the pumped fluid.	6. Use suitable elastomer for pumped fluid and temperatures.
Impermissible temperature increases to pump, bearing support or motor	1. Air in suction line or pump. Suction head too high, NPSH system (supply) too low.	1. Vent and prime suction pipe or pump. Raise suction side liquid level, fully open the stop valve in the suction line.
	2. Bearings have too little, too much or inappropriate lubricant.	2. Add, reduce or replace lubricants.
	3. Pump with bearing support is strained.	3. Install pump without strain, support piping by fixed points. Check coupling alignment.
	4. Axial thrust is too high.	4. Check the relief holes in the impeller and the split rings at the inlet.
	5. Motor protection switch is defective or not set properly.	5. Check the setting, replace the motor protection switch if necessary.
	6. Pressure valve closed.	6. Open pressure valve.

10.4 Repair

10.4.1 Repair order

Compliance with legal regulations on occupational safety requires all commercial companies to protect their workers and the people and the environment from harmful impacts when dealing with hazardous substances.

Follow local laws, regulations and guidelines.

Certificate of non-objection

The certificate of non-objection (Section 12.1, Page 80) attached to this document is part of the inspection/repair order. Nevertheless we reserve the right to reject the acceptance of this order for other reasons.

HILGE products and their parts are therefore inspected/repared only if the certificate of non-objection completed properly and completely by authorised and qualified personnel is submitted.

Pumps that have been operated with radioactive substances are not accepted at all.

If, despite careful emptying and cleaning of the pump, safety precautions are required, the necessary information must be given.

10.4.2 GEA Hilge assembly tool kit

Tools from the GEA Hilge assembly tool kit prevent damage to the mechanical seal during assembly.

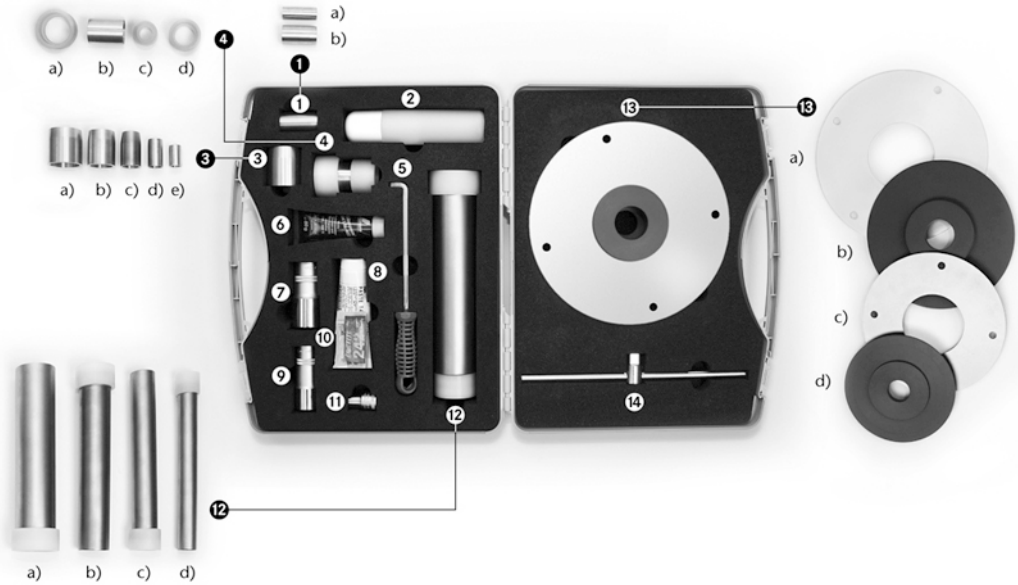

Fig.15: GEA Hilge assembly tool kit

10.4.2.1 Contents and use

Tools in the GEA Hilge assembly tool kit								
Image-pos.	Designation	CONTRA		Image-pos.	Designation	CONTRA		
		N	II			N	II	
1a	Mounting sleeve Ø 19	•		12c	Mechanical seal mounting sleeve Ø 28 and Ø 30		•	
1b	Mounting sleeve Ø 28		•	12c	Plastic adapter Ø 28		•	
2	Spray bottle	•	•	12d	Mechanical seal mounting sleeve Ø 19 and Ø 22	•		
5	Extractor for mechanical seal counter ring	•	•	12d	Plastic adapter Ø 19	•		
6	Klüber paste UH1 96-402	•	•	13a	Impeller nut assembly device		•	
7	Socket wrench a/f 32		•	13b	Impeller nut assembly device, plastic		•	
7	Socket wrench bit a/f 27		•	13c	Impeller nut assembly device	•		
8	Optimol paste TA	•	•	13d	Impeller nut assembly device, plastic	•		
9	Socket wrench a/f 24	•		14	T-handle with 1/2" square	•	•	
9	Socket wrench bit a/f 17	•			Complete assembly tool kit	•	•	
10	Screw locking compound Loctite Type 243	•	•					

10.4.3 Parts overview

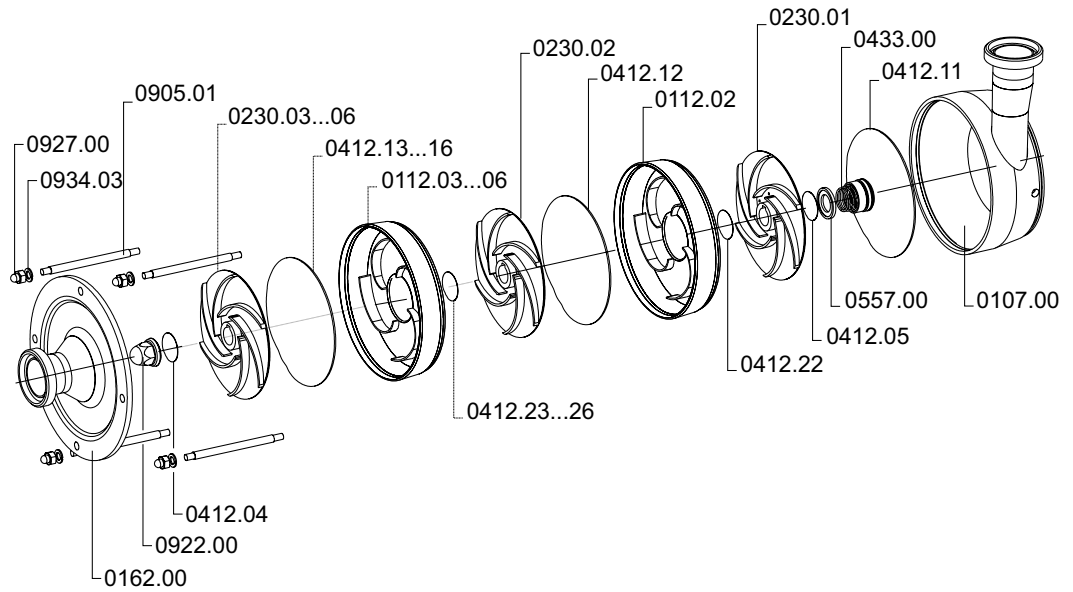

Fig.16: CONTRA parts overview

CONTRA I/II parts list					
Pcs.	Part no.	Description	Pcs.	Part no.	Description
1	0107.00	Discharge casing	1	0412.12	O-ring seal ⁴
1	0112.02	Diffusor casing ⁴	1	0412.13	O-ring seal ⁴
1	0112.03	Diffusor casing ⁴	1	0412.14	O-ring seal ⁴
1	0112.04	Diffusor casing ⁴	1	0412.15	O-ring seal ⁴
1	0112.05	Diffusor casing ⁴	1	0412.16	O-ring seal ⁴
1	0112.06	Diffusor casing ⁴	1	0412.22	O-ring seal ⁴
1	0162.00	Suction cover	1	0412.23	O-ring seal ⁴
1	0230.01	Impeller ⁴	1	0412.24	O-ring seal ⁴
1	0230.02	Impeller ⁴	1	0412.25	O-ring seal ⁴
1	0230.03	Impeller ⁴	1	0412.26	O-ring seal ⁴
1	0230.04	Impeller ⁴	1	0433.00	Axial face seal
1	0230.05	Impeller ⁴	1	0557.00	Seal spacer ⁵
1	0230.06	Impeller ⁴	4	0905.01	Connecting screw
1	0412.04	O-ring seal	1	0922.00	Impeller nut
1	0412.05	O-ring seal ⁵	4	0927.00	Cap nut
1	0412.11	O-ring seal	4	0934.03	Spring washer

⁴ Parts dependent on stages, possibly not pictured.

⁵ Parts dependent on the version of the mechanical seal.

10.4.4 Parts overview for BLOC motor stool

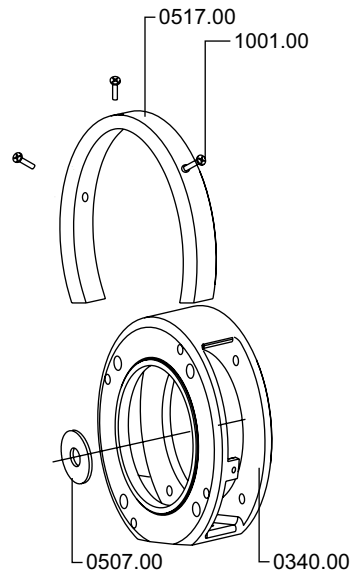

Fig.17: Parts overview

Parts list for BLOC motor stool

Pcs.	Part no.	Designation	Pcs.	Part no.	Designation
1	0340.00	Motor stool	1	0517.00	Shroud support ring ⁶
1	0507.00	Deflector	3	1001.00	Self-tapping screw ⁶

⁶ Only for SUPER version

10.4.5 Parts overview for motor and shroud

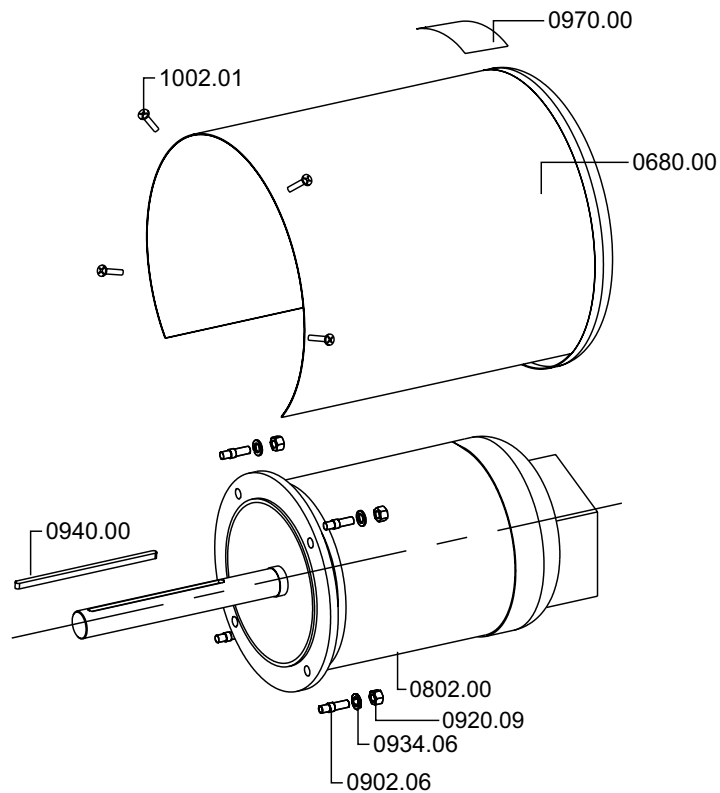

Fig.18: Parts overview

Parts list for motor and shroud					
Pcs.	Parts no.	Designation	Pcs.	Parts no.	Designation
1	0680.00	Shroud hood ⁷	4	0934.06	Spring washer
1	0802.00	Bloc motor	1	0940.00	Key
4	0902.06	Stud screw	1	0970.00	Nameplate
4	0920.09	Hex nut	4	1002.01	Slotted screw ⁷

⁷ Only for SUPER version

10.4.6 Installation instructions

Notice

Hygiene risk, food safety

Improper installation of the pump can cause subsequent contamination that impair food safety.

► Basically, observe the following instructions:

- Use tools from the HILGE assembly tool kit for installation.
 - Check removed parts for damage and wear, and replace if necessary. Use only proper, clean parts for installation. Clean installation space and contact surfaces before installation.
 - In general use only original spare parts.
 - For 3-A applications use only certified original spare parts.
 - Use no mineral oil greases for the wet section assembly.
 - Always replace mechanical seals completely.
 - Carefully handle mechanical seal. Mechanical seal and set ring consist of fragile material.
 - Pay attention to information on replacing the O-rings. See Section 9.3.1.1, Page 46
 - Use suitable tools to tighten the impeller nut (0922.00):
 - Impact wrench
 - Impulse wrench
 - Torque wrench
 - Assembling device for impeller nut
-

10.4.6.1 Cleaning the components before assembly

Notice

Hygiene risk, food safety

Contaminated components contaminate the pump and installation.

► Use suitable chemical cleaning agents to remove impurities in the area of the impeller area, the O-rings or the mechanical seal. Use a brush and / or other tools in order not to damage the surface. Plan contact-free cleaning in an ultrasonic bath to clean the mechanical seal.

10.4.7 Installing the BLOC motor stool

Equipment and tools from the GEA Hilge assembly tool kit

- Klüber paste UH1 96-402

Installing the BLOC motor stool

Fix the BLOC motor stool (0340.00) to the base installation (cast iron foot here) using the studs (0902.05), spring washers (0934.02) and hexagon nuts (0920.02).

torque: M10 - 35 Nm.



Fig.19: BLOC motor stool

Connect the motor (0802.00) to the BLOC motor stool (0340.00) using the studs (0902.06), spring washers (0934.06) and hexagon nuts (0920.09).
torque: M10 - 35 Nm, M12 - 65 Nm, M16 - 150 Nm



Fig.20: Motor

Grease the pump parts on the motor stool (0340.00) with Klüber paste UH1 96-402.



Fig.21: Motor stool contact surface

Pull the deflector (0507.00) onto the shaft (0211.00).



Fig.22: Deflector

→ The BLOC motor stool is mounted.

10.4.8 Fasten discharge casing - simple mechanical seal

Equipment and tools from the GEA Hilge assembly tool kit

- Loctite Type 243
- Klüber paste UH1 96-402

Fasten discharge casing

Coat tie bolts (0905.01) with Loctite type 243 and screw in hand-tight (!) into the bearing housings (ADAPTA version) or motor stool (BLOC version).



Fig.23: Tie bolts

Grease rear of the discharge casing (0107.00) with Klüber paste.



Fig.24: Discharge casing, rear

Push the discharge casing (0107.00) over the shaft (0211.00) - for BLOC version of the motor shaft.

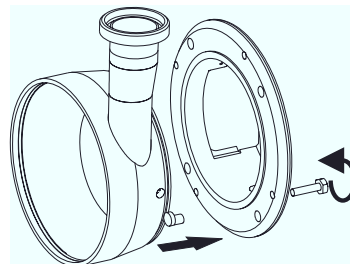

Fig.25: Assembly screws for CONTRA II



Fig.26: Discharge casing and shaft

Use assembly screws when installing CONTRA II so that the larger discharge casing (0107.00) of CONTRA II is held in place. It will then not fall on the shaft (0211.00) during assembly.

→ The discharge casing is fastened.

10.4.9 Installing single conical spring mechanical seal

Equipment and tools from the GEA Hilge assembly tool kit

- Spray bottle
- Mounting sleeve
- Installation sleeve

Installing single conical spring mechanical seal

Wet the stationary ring (counter ring) of the mechanical seal (0433.00) and the shaft (0211.00) - for BLOC version of the motor shaft - with clean water.



Fig.27: Stationary ring of the mechanical seal

Push the stationary ring of the mechanical seal (0433.00) with the installation sleeve into the seat of the discharge casing (0107.00).



Fig.28: Fixed ring of the mechanical seal and discharge casing

Wet the mounting sleeve with clean water and push it onto the shaft shoulder.
HILGE assembly tools prevent damage to the mechanical seal during further assembly.



Fig.29: Mounting sleeve

Installing single conical spring mechanical seal

Push the rotating unit of the mechanical seal (0433.00) wet with clean water and installation sleeve in the assembled state as far as it will go onto the connection (0211.00).



Fig.30: Rotating unit of the mechanical seal

Push seal spacer (0577.00) on the shaft (0211.00).



Fig.31: Seal spacer

→ The single conical spring mechanical seal has been installed.



Hint!

For further assembly information refer to "Installing impeller and housing" section.

10.4.10 Installing the single mechanical seal - spring encapsulated (hygiene)

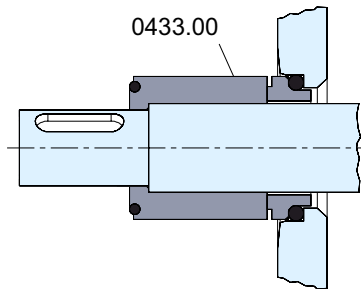

Fig.32: Single hygienic mechanical seal
0433.00 mechanical seal

Features

- Encapsulated spring
- Sealing towards the impeller
- Easy to clean
- For adhesive media
- Optimal arrangement in the pump chamber

Equipment and tools from the GEA Hilge assembly tool kit:

- Spray bottle
- Plastic mounting sleeve

Prior to installation

1. Check the shaft and counter ring holder for impurities and damage (sharp edges). If necessary, clean or replace parts.

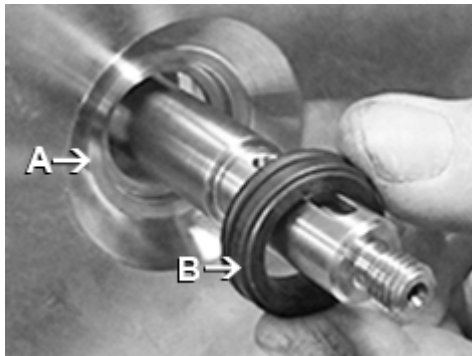

Fig.33: Shaft and counter ring holder
A - Counter ring holder | B - Stationary ring of the mechanical seal (counter ring)

Notice

Hygiene risk, food safety

Danger due to contamination

- ▶ Carefully inspect the seat of the mechanical seal.
- ▶ Pay attention to groove and pin for mechanical seal with anti-twist protection.

2. Check all O-rings of the mechanical seal for correct seating, and adjust if necessary.
3. Moisten all sliding O-rings with water.
→ Done.

Assembly

1. Slide the stationary ring (counter ring) of the mechanical seal (0433.00) along with the O-ring over the shaft into the seat.
On a version with anti-twist protection, the slot and pin positions must match.
2. Push the rotating part of the mechanical seal (0433.00) in the assembled state onto the shaft as far as it will go using a slight rotating motion.
→ The mechanical seal has been installed.



Hint!

For further assembly information refer to "Installing impeller and housing" section.

10.4.11 Installing double mechanical seal



Hint!

This section applies to the installation of the double mechanical seal in back-to-back and tandem arrangements

Equipment and tools from the GEA Hilge assembly tool kit

- Spray bottle
- Plastic mounting sleeve
- Mounting sleeve
- Loctite Type 243
- Klüber paste UH1 96-402
- Extractor
- Socket wrench with plastic insert

Arrangements for double mechanical seals

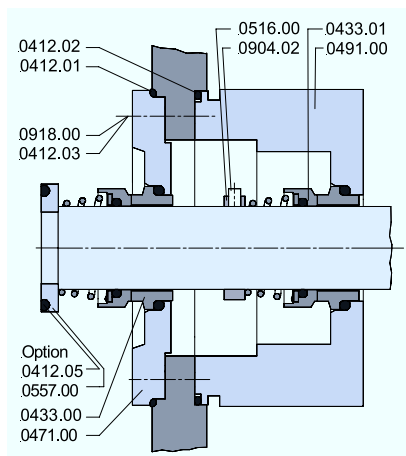

Fig.34: Tandem double mechanical seal (CONTRA I)

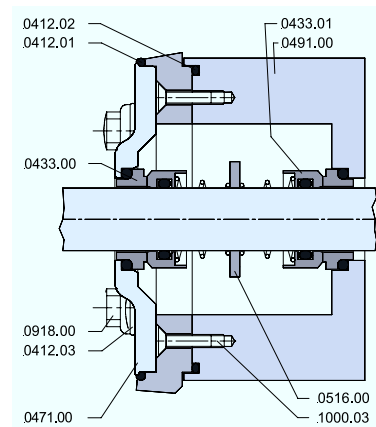

Fig.35: Double back-to-back mechanical seal (CONTRA I)

Installing double mechanical seal

Coat tie bolts (0905.01) with Loctite type 243 and screw in hand-tight (!) into the bearing housings (ADAPTA version) or motor stool (BLOC version).



Fig.36

Insert the O-ring (0412.01) into the seal cartridge (0491.00).



Fig.37

Press the seal cartridge (0491.00) into the seat of the discharge casing (0107.00).



Fig.38: Discharge casing with seal cartridge

Connect the seal cartridge (0491.00) with the discharge casing (0107.00)
GEA Hilge CONTRA I: Fastening from the front with countersunk screws (1000.03) Torque: 1.5 - 2 Nm
GEA Hilge CONTRA II: Fastening from the rear with hex socket screws (0914.02), washer (0554.03).
torque: 8 Nm



Fig.39

Installing double mechanical seal

Connecting the seal cartridge GEA Hilge CONTRA I / II

The seal cartridge is required for the double mechanical seal. Its mounting is very similar for the GEA Hilge CONTRA I and GEA Hilge CONTRA II.

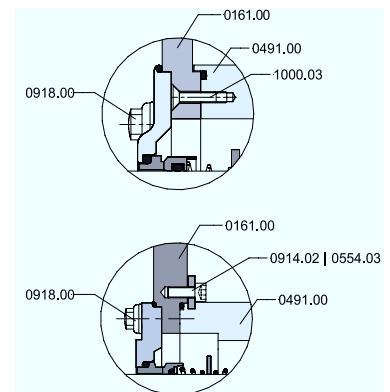

Fig.40: Connection of seal cartridge
top: GEA Hilge CONTRA I | bottom:
GEA Hilge CONTRA II

Grease the rear of the discharge casing (0107.00) with Klüber paste.



Fig.41: Contact surface of
discharge casing / drive
end part

Push the discharge casing (0107.00) over the shaft (0211.00) - for BLOC version of the motor shaft.
Use assembly screws for CONTRA II.



Fig.42: Discharge casing, shaft

Installing double mechanical seal

Assembly screws for CONTRA II

Use assembly screws for CONTRA II to hold the discharge casing (0107.00) in place during assembly. It will then not tilt on the shaft (0211.00).

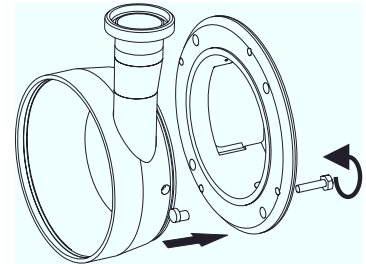

Fig.43: CONTRA II assembly screws

Wet the fixed ring (stationary ring) of the mechanical seal (0433.01) and the shaft (0211.00) with clean water.



Fig.44: Stationary ring of the mechanical seal

Push the fixed ring (stationary ring) of the mechanical seal (0433.01) with the mounting sleeve into the seat of the seal cartridge (0491.00).



Fig.45: Set ring of the mechanical seal

Wet the mounting sleeve with clean water and push it onto the shaft shoulder
HILGE assembly tools prevent damage to the mechanical seal during further assembly.

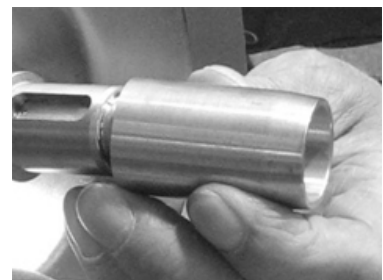

Fig.46: Mounting sleeve

Installing double mechanical seal

Push the rotating unit (rotary ring) of the mechanical seal (0433.01) into the shaft (0211.00) as far as it will go in the assembled state with the mounting sleeve.



Fig.47: Rotary ring of the mechanical seal

Remove the mounting sleeve.

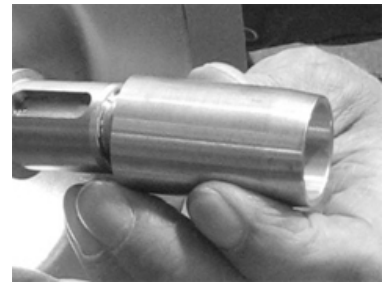

Fig.48: Mounting sleeve

→ The mechanical seal on the atmosphere side has been installed.



Hint!

Further installation steps

- Installing the mechanical seal in tandem arrangement: continue with Section 10.4.12, Page 67
- Installing the mechanical seal in back-to-back arrangement: continue with Section 10.4.13, Page 69.

10.4.12 Installing tandem double mechanical seal

Equipment and tools from the GEA Hilge assembly tool kit

- Spray bottle
- Plastic mounting sleeve
- Mounting sleeve
- Loctite Type 243
- Klüber paste UH1 96-402
- Extractor
- Socket wrench with plastic insert

Installing tandem double mechanical seal

Screw set screws (0904.02) one or two turns into the adjusting ring (0516.00) and wet with Loctite 243.

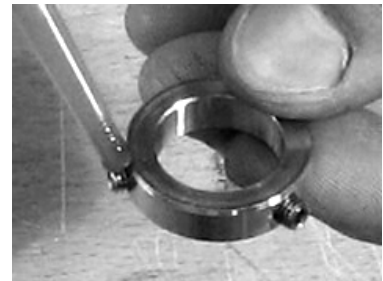

Fig.49: Adjusting ring

Push the adjusting ring (0516.00) to the correct position on the shaft, using a suitable measuring tool.

Lock the adjusting ring (0516.00) with the set screws (0904.02).



Fig.50: Position of the adjusting ring

Relieve the spring of the mechanical seal (0433.01) against the adjusting ring (0516.00), using the extractor.



Fig.51: Extractor

Installing tandem double mechanical seal

Wet the O-ring (0412.03) with water and insert it into the sterile screws (0918.00).



Fig.52: Sterile screw

Insert the O-ring (0412.01) into the seal cover (0471.00).

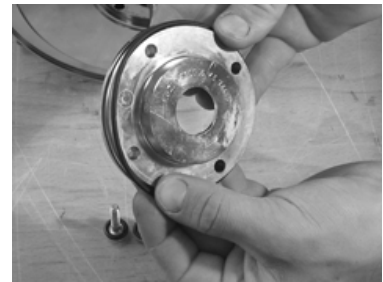

Fig.53: Seal cover

Use the sterile screws (0918.00) to fasten the seal cover (0471.00) to the back plate (0161.00).
torque: M6: 8 Nm

Notice

Hygiene risk, food safety

Hygiene risk, food safety

- ▶ Always tighten sterile screws with socket wrench and insert.

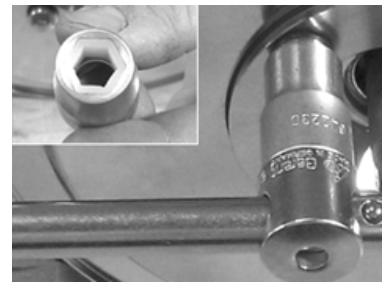

Fig.54: Seal cover

→ The mechanical seal on the atmosphere side has been installed.



Hint!

The next steps for installing the product-side mechanical seal are identical to installing the simple mechanical seal. For a conical spring mechanical seal, follow the steps in Section 10.4.9, Page 58. For an encapsulated hygienic mechanical seal, follow the steps in Section 10.4.9, Page 58.

10.4.13 Installing double mechanical seal in back-to-back position

Installing double mechanical seal in back-to-back position



Hint!

Start by following the steps in Section 10.4.11, Page 62.

Push the locating ring (0516.00) onto the shaft (0211.00) - for BLOC version of the motor shaft.

Wet the mounting sleeve with clean water and push it onto the shaft shoulder.

HILGE assembly tools prevent damage to the mechanical seal during further assembly.

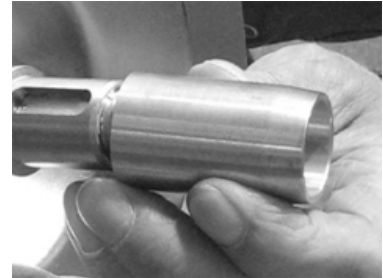

Fig.55: Mounting sleeve

Push the rotating unit (rotary ring) of the mechanical seal (0433.00) onto the shaft (0211.00) as far as it will go in the assembled state with the mounting sleeve - for BLOC version of the motor shaft.



Fig.56: Rotary ring of the mechanical seal

Insert the stationary ring (counter ring) of the mechanical seal (0433.00) into the seat of the seal cover (0471.00).



Fig.57: Stationary ring in seal cover

Installing double mechanical seal in back-to-back position

Insert the O-ring (0412.01) into the seal cover (0471.00).

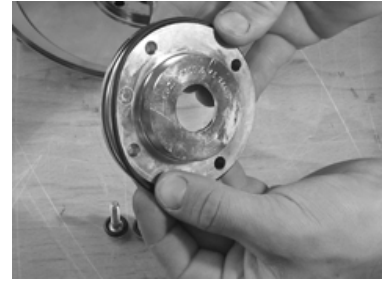

Fig.58: Seal cover

Wet the O-ring (0412.03) with water and insert it into the sterile screws (0918.00).



Fig.59: Sterile screw

Use the sterile screws (0918.00) to fasten the seal cover (0471.00) to the back plate (0161.00).
torque: M6: 8 Nm

Notice

Hygiene risk, food safety

Hygiene risk, food safety

- ▶ Always tighten sterile screws with socket wrench and insert.



Fig.60: Seal cover

→ The mechanical seal on the atmosphere side has been installed.



Hint!

The next steps for installing the product-side mechanical seal are identical to installing the simple mechanical seal. For a conical spring mechanical seal, follow the steps in Section 10.4.9, Page 58. For an encapsulated hygienic mechanical seal, follow the steps in Section 10.4.9, Page 58.

10.4.14 Installing impeller and housing

Equipment and tools from the GEA Hilge assembly tool kit:

- Klüber paste UH1 96-402
- Extractor
- Spray bottle
- Impeller nut assembly device
- Impeller nut assembly device, plastic
- Socket wrench
- Socket wrench bit

Install impeller

Insert the key (0940.00).



Fig.61: Key

Insert the O-ring (0412.05) into the seal spacer (0557.00) or mechanical seal (0433.00).
(This step is not required for the encapsulated hygienic mechanical seal.)



Fig.62: O-ring

Grease impeller seat and shaft thread with Klüber paste.



Fig.63: Impeller seat

Install impeller

Release the mechanical seal spring (0433.00) by pushing the extractor against the seal spacer (0557.00)
(This step is not required for the encapsulated hygienic mechanical seal.)



Fig.64: Conical spring of the mechanical seal

Insert the O-ring (0412.11) into the discharge casing (0107.00).



Fig.65: O-ring

Install impeller (0230.01).

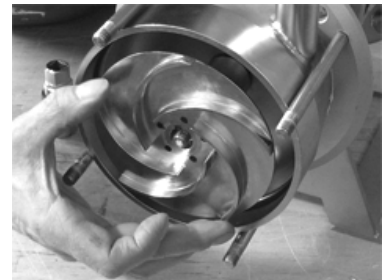

Fig.66: Impeller

Install the diffuser casing (0112.02).



Fig.67: Diffusor casing

Install impeller

Insert the O-ring (0412.12) into the diffuser casing (0112.12).



Fig.68: O-ring

Insert the O-ring (0412.22) into the impeller (0230.02).



Fig.69: Impeller, O-ring

Install second impeller (0230.02).



Fig.70: Impeller

To install the remaining stages, repeat steps Figure 67, Page 72 to Figure 70, Page 73. Observe the different part numbers of the impellers, diffuser casings and O-rings.

Grease the thread of the impeller nut (0922.00) with Klüber paste.



Fig.71: Impeller nut

Install impeller

Grease lock washer (0930.00) with Klüber paste.



Hint!

Only use original part lock washers from GEA Hilge for securing the impeller mounting.

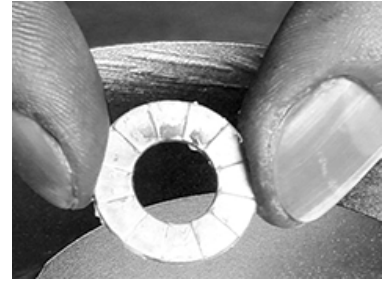

Fig.72: Lock washers

Grease lock washers as shown.

- (0230.00) Impeller | (0412.04) O-ring
- (0922.00) Impeller nut
- (A) Fine gearing - greased
- (B) Coarse gearing against each other - greased

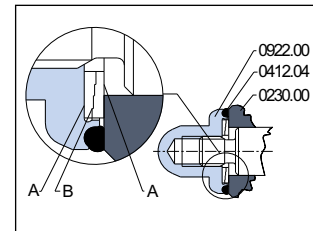

Fig.73: Grease overview

Replace lock washers (0930.00) after 5-time use.

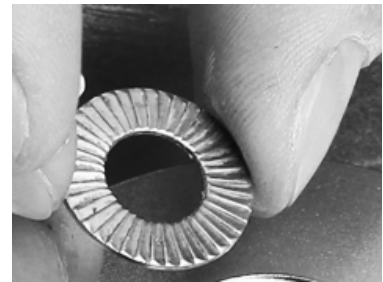

Fig.74: Lock washer

Insert the lock washers (0930.00) into the impeller nut (0922.00).

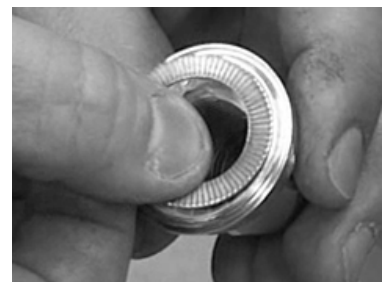

Fig.75: Lock washers in impeller nut

Install impeller

Unscrew impeller nut (0922.00) by hand. Leave a gap of about 3 mm for the O-ring (0412.04).



Fig.76: Impeller nut

Wet the O-ring (0412.04) with water and use the impeller nut (0922.00) to push it into the gap between the impeller nut (0922.00) and the impeller (0230.00).



Fig.77: O-ring

Push plastic impeller nut assembly aid over impeller nut. Then place metal plate on tie bolts (0905.01).



Fig.78: Impeller nut assembly device

Fasten impeller nut assembly device with the domed nuts (0927.00).



Fig.79: Impeller nut assembly device

Install impeller

To prevent damage, use socket wrench with bit to tighten the impeller nut (0922.00).

Tighten the impeller nut (0922.00).

Torques:

GEA Hilge CONTRA I: M10: 20 Nm (15 lbf ft)

GEA Hilge CONTRA II: M20 x 1.5: 100 - 120 Nm (74 - 89 lbf ft)

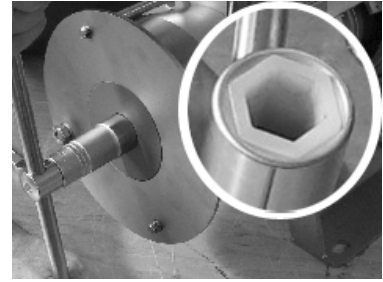

Fig.80: Hexagon nut with insert

Notice

Hygiene risk, food safety

Damaged and scratched surfaces can cause contamination.

- ▶ Always tighten impeller nut with socket wrench and insert.

Install the suction cover (0162.00).



Fig.81: Suction cover

Grease the thread of the tie bolts (0905.01) with Klüber paste.



Fig.82: Tie bolts

Fasten the suction cover (0162.00), using the spring washers (0934.03) and domed nuts (0927.00).

torque: 20 Nm

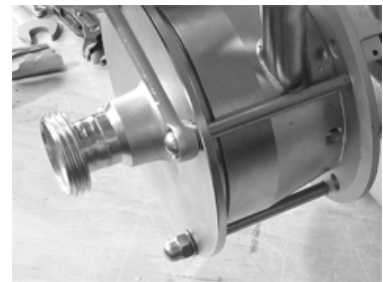

Fig.83: Suction cover, domed nuts

Install impeller

Ensure that the pump shaft can be tuned easily.

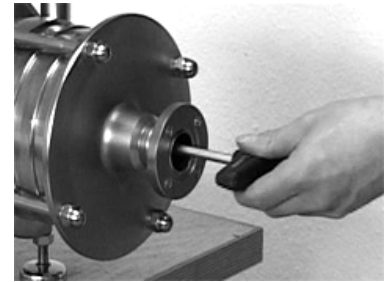

Fig.84: Check rotation

Retighten domed nuts (0927.00) approx.
30 minutes after initially tightening them. Due to
the O-rings, the screw connection needs to set
first.

→ The impellers and housings are now mounted.

11 Decommissioning

11.1 Special personnel qualification

The decommissioning personnel must be suitably qualified for this work. See also Section 2.6, Page 14.

11.2 Safety instructions

Warning!

Pressure shock!

- ▶ Always close shut-off devices (gates, valves) slowly.
- ▶ A pressure shock is a sudden increase in pressure in the system. This pressure increase may be triggered by quickly shutting off the flow in the pressure pipe, in addition to other causes. If a pressure shock occurs, the max. permissible pump pressure is briefly exceeded by a multitude.

Caution!

Sticking of the pump.

- ▶ Clean the pump suitably after decommissioning. See "Cleaning" section.

11.3 Temporary decommissioning

Warning!

Pressure shock!

- ▶ Always close shut-off devices (gates, valves) slowly.
- ▶ A pressure shock is a sudden increase in pressure in the system. This pressure increase may be triggered by quickly shutting off the flow in the pressure pipe, in addition to other causes. If a pressure shock occurs, the max. permissible pump pressure is briefly exceeded by a multitude.

Perform the following steps:

1. Close the pressure side shut-off valve.
2. Switch off the pump.
3. Close the suction side shut-off valve.
4. Switch off the flushing.
5. Make sure that the pump is depressurised.
6. Depressurise the sealing system.
→ The pump has been temporarily decommissioned.

11.4 Disposal

Discard the pump or parts thereof in an environment-friendly manner: Use the service of public or private disposal companies. If this is not possible, contact the next GEA Hilge company or service centre.

12 Appendix

12.1 Certificate of non-objection

Certificate of non-objection

This section contains a certificate of non-objection. In the event of inspection or repair send the pump including this certificate to HILGE.

Certificate of non-objection

The following pump and its accessories, together with this certificate of non-objection, are herewith contracted out by the undersigned for inspection/repair:

Pump data

- Model:
- No.:
- Delivery date:
- Reason for inspection / repair contract

The pump (please mark with a cross)

was not used in liquids hazardous to health

was used for the following:

Please state the last liquid pumped, if known:

The pump was carefully drained and also cleaned inside and out before it was shipped/made available. (please mark with a cross).

No special safety measures are required in the course of further handling.

The following safety measures pertaining to flushing liquids, residual liquids, and disposal are required:

We confirm that the information given above is correct and complete and that shipment is in compliance with legal regulations.

Company (address):

Telephone: _____

Fax: _____

Email: _____

Name (incl. title) _____

(please print): _____

Date: _____

Company stamp / signature: _____



We live our values.

Excellence • Passion • Integrity • Responsibility • GEA-versity

GEA is a global technology company with multi-billion euro sales operations in more than 50 countries. Founded in 1881 the company is one of the largest providers of innovative equipment and process technology. GEA is listed in the STOXX® Europe 600 Index. In addition, the company is included in selected MSCI Global Sustainability Indexes.

GEA Germany

GEA Hilge

Niederlassung der GEA Tuchenhagen GmbH

Hilgestraße 37–47

55294 Bodenheim, Germany

Tel +49 6135 7016-0

Fax +49 6135 1737

info@gea.com

gea.com