

SRUT

Reducing Union Tee

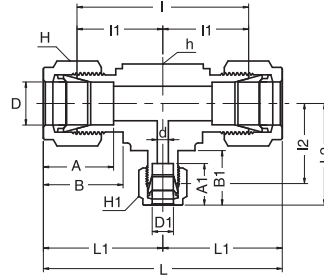

Connects Fractional Tubes

| Part No. | Tube OD | | d Min | Width Across Flat | | | A | A1 | B | B1 | I | I1 | I2 | L | L1 | L2 |
|----------------|----------|-----------|----------|-------------------|----------|-----------|-------|-------|-------|-------|-------|-------|-------|-------|-------|-------|
| | D (inch) | D1 (inch) | | h (inch) | H (inch) | H1 (inch) | | | | | | | | | | |
| SRUT - 6 - 4 | 3/8 | 1/4 | 4.82 | 5/8 | 11/16 | 9/16 | 16.76 | 15.24 | 19.30 | 17.78 | 46.22 | 23.11 | 21.59 | 60.96 | 30.48 | 28.95 |
| SRUT - 8 - 4 | 1/2 | 1/4 | 4.82 | 13/16 | 7/8 | 9/16 | 22.86 | 15.24 | 21.84 | 17.78 | 51.81 | 25.90 | 24.38 | 72.13 | 36.06 | 31.75 |
| SRUT - 8 - 6 | 1/2 | 3/8 | 7.11 | 13/16 | 7/8 | 11/16 | 22.86 | 16.76 | 21.84 | 19.30 | 51.81 | 25.90 | 25.90 | 72.13 | 36.06 | 33.27 |
| SRUT - 10 - 6 | 5/8 | 3/8 | 7.11 | 1 | 1 | 11/16 | 24.38 | 16.76 | 21.84 | 19.30 | 57.40 | 28.70 | 28.70 | 77.72 | 38.86 | 36.06 |
| SRUT - 12 - 6 | 3/4 | 3/8 | 7.11 | 1 1/16 | 1 1/8 | 11/16 | 24.38 | 16.76 | 21.84 | 19.30 | 59.43 | 29.71 | 29.71 | 79.75 | 39.87 | 37.08 |
| SRUT - 12 - 8 | 3/4 | 1/2 | 10.41 | 1 1/16 | 1 1/8 | 7/8 | 24.38 | 22.86 | 21.84 | 21.84 | 59.43 | 29.71 | 29.71 | 79.75 | 39.87 | 39.87 |
| SRUT - 16 - 6 | 1 | 3/8 | 7.11 | 1 3/8 | 1 1/2 | 11/16 | 31.24 | 16.76 | 26.41 | 19.30 | 73.66 | 36.83 | 34.54 | 98.04 | 49.02 | 41.91 |
| SRUT - 16 - 8 | 1 | 1/2 | 10.41 | 1 3/8 | 1 1/2 | 7/8 | 31.24 | 21.84 | 26.41 | 22.86 | 73.66 | 36.83 | 34.54 | 98.04 | 49.02 | 44.70 |
| SRUT - 16 - 12 | 1 | 3/4 | 15.74 | 1 3/8 | 1 1/2 | 1 1/8 | 31.24 | 24.38 | 26.41 | 21.84 | 73.66 | 36.83 | 34.54 | 98.04 | 49.02 | 44.70 |

- Dimensions and Drawings are for reference only and are subject to change without prior notice.
 - Unless otherwise specified, all dimensions are in millimeters.
 - Sizes, pressure classes, and end connections not listed are available upon request.
 - Dimensions shown with SUPERLOK nuts finger-tight, where applicable.