

# Instruction Manual



Anderson Instrument Co. Inc.  
156 Auriesville Road  
Fultonville, NY 12072  
1-800-833-0081  
Fax 518-922-8997

[www.andinst.com](http://www.andinst.com)

Instrument Model Number \_\_\_\_\_

Instrument Serial Number \_\_\_\_\_

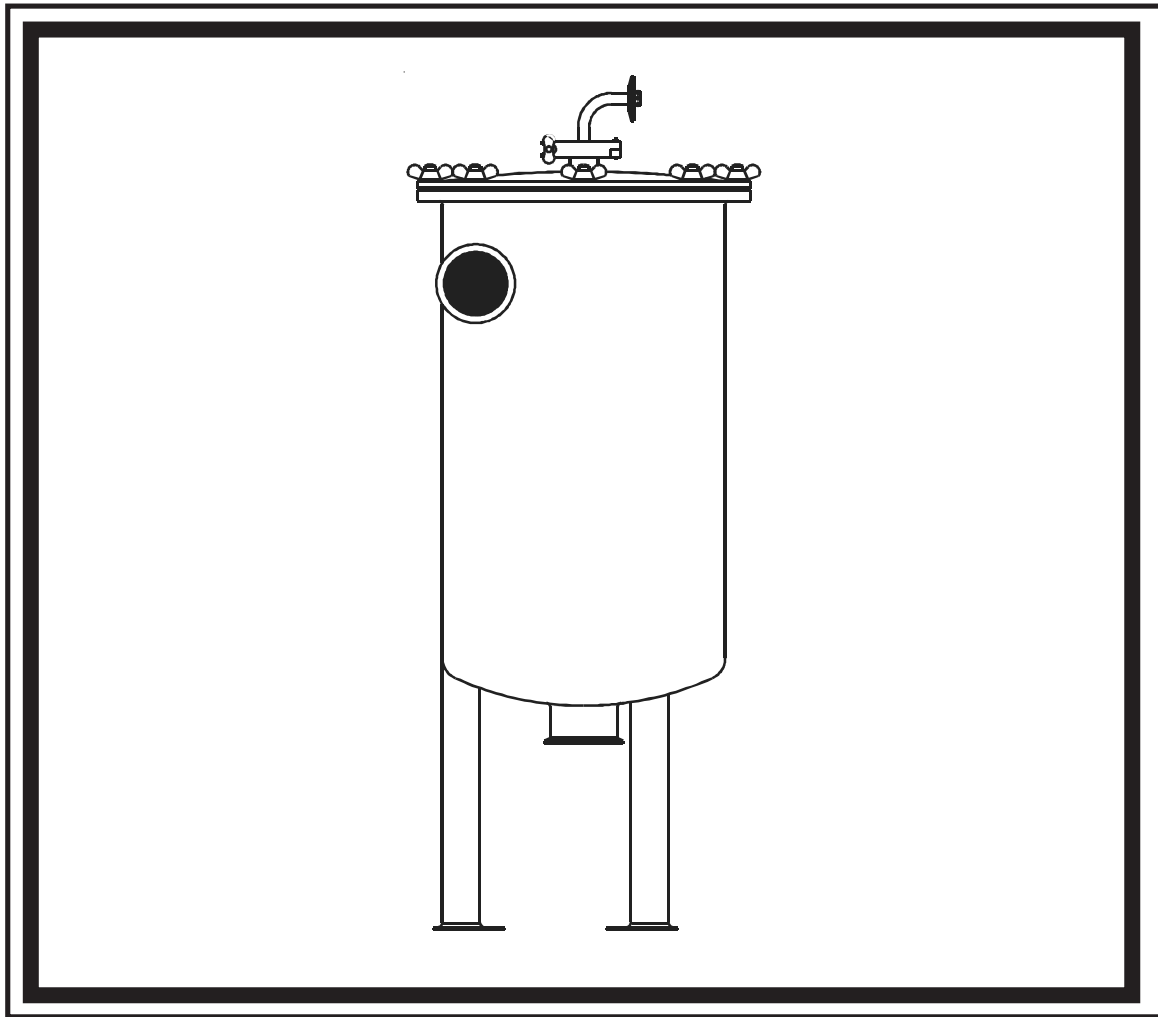

## **AIR ELIMINATOR**



---

## Table of Contents

<b>1. GENERAL .....</b>	<b>3</b>
1.1 Description	
<b>2 VESSEL DIMENSIONS .....</b>	<b>3</b>
<b>3. INSTRUCTIONS .....</b>	<b>4</b>
3.1 Assembly	
3.2 Installation	
<b>4. PARTS LIST .....</b>	<b>5</b>
<b>Appendix A - Warranty and Return Statement .....</b>	<b>6</b>

# 1. GENERAL

## 1.1 Description

This manual contains instructions for the Anderson AE Series Air Eliminator. Be sure to identify the model that you will be installing, and to properly follow all procedures as listed.

Be sure to check shipping carton upon removal of parts. If carton shows evidence of damage, notify carrier immediately. Contents of package should include:

- Vortex Breaker
- Float Guide
- Float
- Gasket and Cover
- 8 Washers and Wing Nuts
- Air Vent Tube

# 2. VESSEL DIMENSIONS

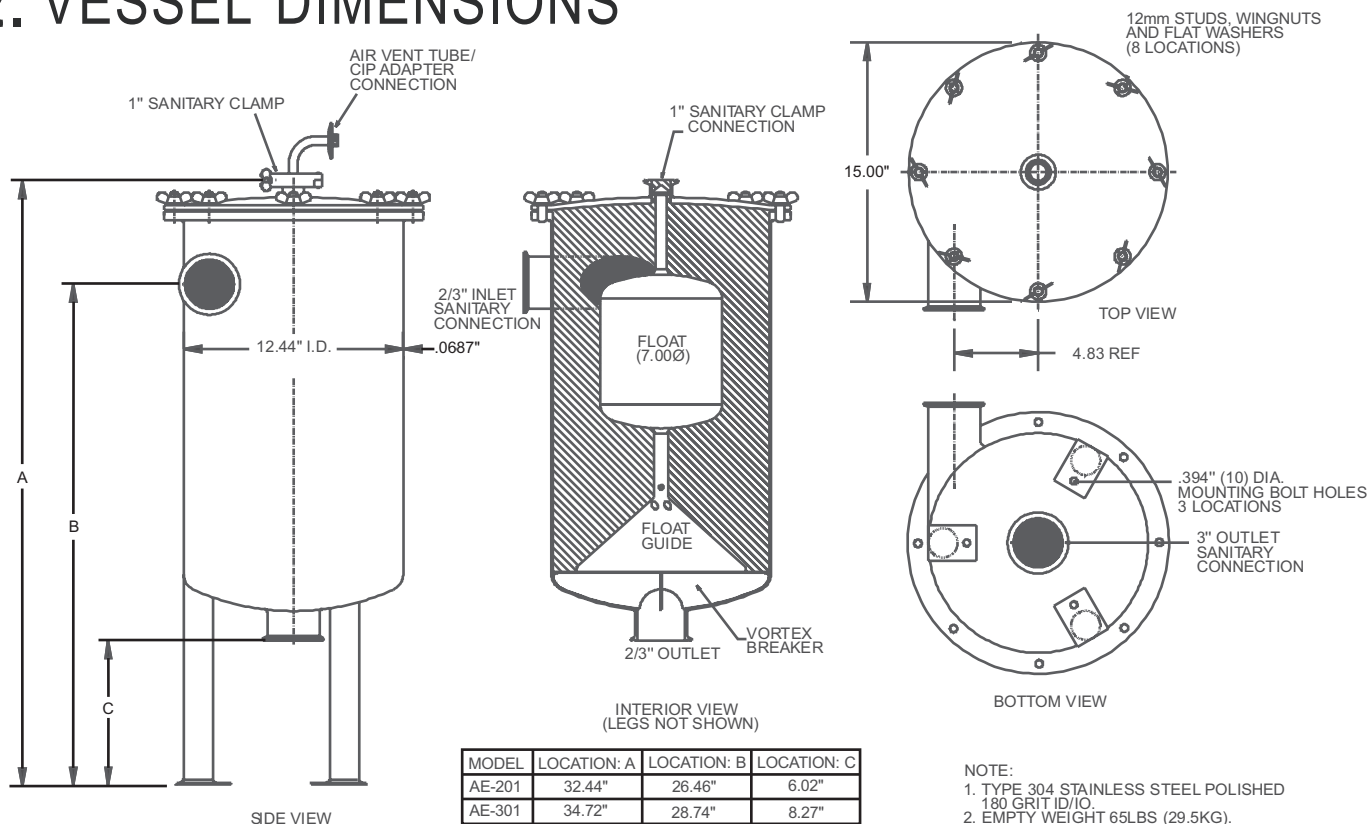

---

## 3. INSTRUCTIONS

### 3.1 ASSEMBLY

1. Install the vortex breaker with curvature matching the bottom of the tank. The stop pin on the bottom of the tank will not allow the vortex breaker to spin.
2. Install the float with the guide stem into the tube on the float guide.
3. Fit the gasket on the air eliminator, and carefully install cover making sure gasket sits on cover and tank properly.
4. Tighten nuts at diametrically opposing points for even pressure across the cover.
5. Install vent elbow rubber side down for normal air eliminator operation. Reverse vent tube for CIP operation

### 3.2 INSTALLATION

Air eliminator should be installed as close to the pump as possible. The pump should be mounted before the air eliminator. Any type of inline filter must be placed after the air eliminator. Inlet and outlet pipe alignment is very important to the life and operation of the air eliminator. There should be no tension at the inlet and outlet of the air eliminator where the clamp connections are made. Piping should be "lined up" and/or supported accordingly. Any line vibration at these connections must be avoided. Connections on the suction side of the pump must be gasketed and tight. A check valve should be installed after the air eliminator.

For proper operation it is important to avoid restrictions on the suction side of the pump. When unloading from tank trucks with 2" connection or when using 2" hose, flow rate should be limited to approximately 150 GPM. Maximum flow rate for a 3" connection and hose should be limited to 300 GPM. The pump and air eliminator should be low enough to allow gravity fill through to the air eliminator upon start-up.

For efficient operation in receiving installations the tank truck should sit on an incline. A pitch of 1 in 24 (1/2" rise per ft. length of truck) is recommended.

FIGURE 1 - INSTALLATION/PIPING DIAGRAM

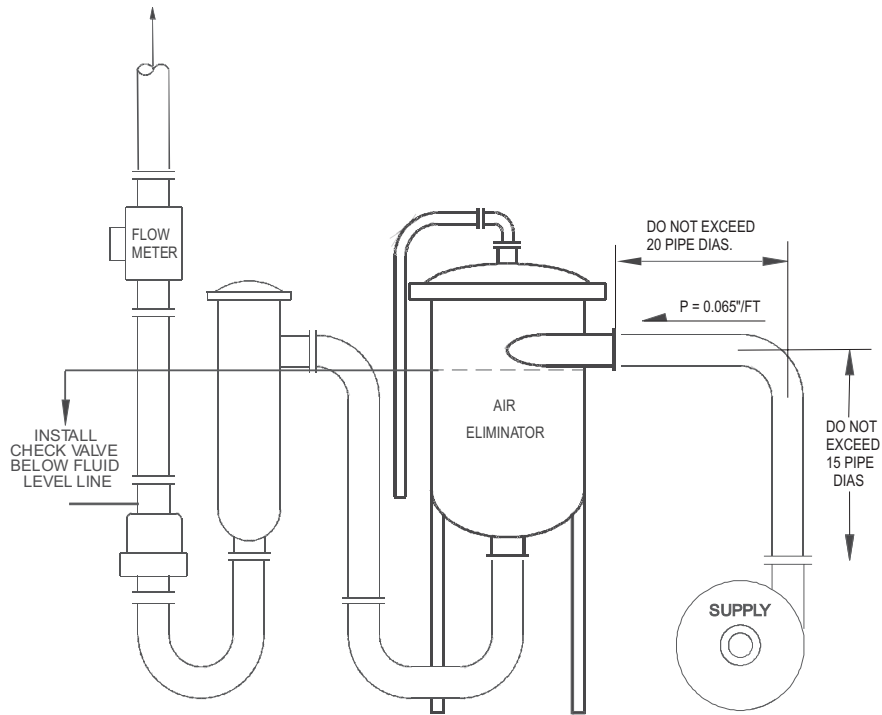

## 4. PARTS LIST

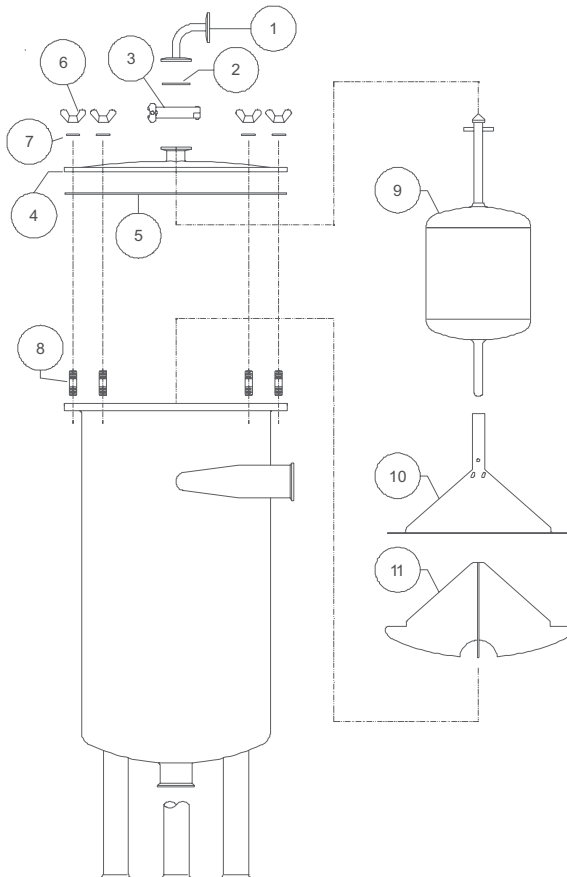

ITEM	PART NUMBER	QTY.	DESCRIPTION
1	AE-300-1	1	AIR VENT TUBE / CIP ADAPTER
2	GC40-1.5	1	1 1/2" SANITARY GASKET
3	GH13LAH-1.5	1	1 1/2" SANITARY CLAMP
4	AE-300-3	1	COVER
5	8050712-01	1	COVER GASKET
6	RZ32-6	8	12mm ST. STL. WINGNUT
7	SM35-02	8	ST. STL. FLAT WASHER
8	SM35S-02	8	12mm ST. STL. STUD
9	AE-300-9	1	FLOAT
10	AE-300-10	1	FLOAT GUIDE
11	AE-300-11	1	VORTEX BREAKER

BOTH MODELS 201/301 USE SAME REPLACEMENT PARTS IN CHART ABOVE.

